



21st Annual Conference on Problem Gambling Prevention, Research, Recovery & Treatment

June 8-10, 2007
Kansas City, MO

Sponsored by :
National Council on Problem Gambling
Midwest Consortium on Problem Gambling and Substance Abuse

Hosted by :
Missouri Alliance to Curb Problem Gambling
Missouri Council on Problem Gambling Concerns, Inc.

Administered by:
Prairielands ATTC

**Improving Practice and Managing Consequences
for Problem Gambling, Substance Abuse
and Co-Occurring Disorders**

We look forward to seeing you in June!



**Tickets are required
for the optional
Kansas City Style Barbecue
& Museum Reception* on
Friday night!**

**Tickets can be purchased when you
complete your on-line registration, or you
can call the NCPG office (202-547-9204)
to add as many tickets as you would like
to your registration.**

** See page 8 for details...*



Table of Contents

Welcome to the 2007 National & Midwest Conference	2
Conference Tips	5
Hotel Information: Kansas City Downtown Marriott & Points of Interest.....	6
Floor Maps for conference events	6
<u>Agenda</u>	
Snapshot View of Conference Agenda	9
Conference Schedule	10
<u>Speakers & Presenters</u>	
Keynote Addresses and Featured Presenters	21
Addiction and Problem Gambling: The State of the State’s Involvement.....	21
Future Issues in Gambling and Problem Gambling	22
Methamphetamine and the Brain, Implications for Behavior and Thought.....	23
Problem Gambling and Substance Abuse Best Practices: Pharmacology and Cravings	23
Developmental Perspective on Youth, Gambling, and Substance Abuse.....	24
Presenter Biographies	25
<u>Awards</u>	
NCPG 2007 Awards	39
2007 People’s Choice Award - Print Campaign Submissions	40
<u>Acknowledgements</u>	
2007 Conference Planning Team.....	44
Conference Committee	45
Conference Contributors, Volunteers and Staff.....	46
Conference Sponsors	47
Conference Exhibitors	47
<u>2008 Planning</u>	
National Problem Gambling Awareness Week - March 9-15, 2008	51
22nd Annual Conference on Problem Gambling	51
2008 Midwest Conference on Problem Gambling and Substance Abuse.....	513

Contact Information

National Conference Committee	Midwest Conference Committee
<p>The National Council on Problem Gambling 216 G Street NE, Suite 200 Washington, D.C. 20002</p> <p>Phone: 202-547-9204 Fax: 202-547-9206 E-mail: ncpg@ncpgambling.org www.ncpgambling.org</p>	<p>Prairielands ATTC Attn: Midwest Conference on Problem Gambling & Substance Abuse University of Iowa 1207 Westlawn Iowa City, IA 52242 Phone: 319-335-5362 Fax: 319-335-6068 E-mail: Candace-peters@uiowa.edu www.888betsoff.org/links/midwest_conference.shtm</p>

Welcome to the 2007 National & Midwest Conference



National Council
on Problem Gambling

216 G Street, NE, Suite 200
Washington, DC 20002
www.ncpgambling.org

T (202) 547 9204 F (202) 547 9206
National Helpline (800) 522 4700

June 8, 2007

Welcome to the *21st National Conference on Problem Gambling Prevention, Treatment, Research and Recovery: Improving Practice and Managing Consequences for Problem Gambling, Substance Abuse and Co-Occurring Disorders*. This year's conference is especially significant in that it occurs thirty-five years to the day that the National Council on Problem Gambling was founded on June 8, 1972.

From its outset, the NCPG has been guided by two principles that remain in effect today: the organization would be the advocate for problem gamblers and their families, and it would take no position for or against legalized gambling. As the national advocate for programs and services to assist problem gamblers and their families, NCPG bears a tremendous responsibility to the millions of Americans affected by this devastating disorder who face stigma and shame, struggle with indifference and ignorance, and lack legal protection or public services.

The National Council works with a wide variety of stakeholders, including federal, state and tribal government, gaming industry, media, universities and colleges, healthcare providers and recovering gamblers to reduce the harm and change public perception of problem gambling.

On behalf of the NCPG Board of Directors, we thank you for your participation in our annual conference. We hope you will continue to work with us on the local, state and national level to help problem gamblers and their families. We also would like to thank our conference sponsors for their generous support. Please let us know how we can help you.

Sincerely,

Handwritten signature of Dennis McNeilly in black ink.

Dennis McNeilly, S.J., Psy.D.
President

Handwritten signature of Keith Whyte in black ink.

Keith Whyte
Executive Director



**Midwest Conference on
Problem Gambling &
Substance Abuse**

c/o Prairielands ATTC
The University of Iowa
College of Public Health
Community & Behavioral Health
1207 Westlawn
Iowa City, Iowa 52242
Phone: (319) 335-5362
Fax: (319) 335-6068

**Midwest Conference
Consortium**

Iowa Department of Public Health

Kansas Association of Addiction
Professionals

Kansas Coalition on Problem
Gambling

Kansas Department of Social &
Rehabilitation Services,
Healthcare Policy, Addiction and
Prevention Services

Eisenbarth & Associates

Missouri Council on Problem
Gambling Concerns, Inc.

Missouri Department of Mental
Health, Division of Alcohol & Drug
Abuse

Missouri Gaming Association

Missouri Gaming Commission

Missouri Lottery

Nebraska Council on Compulsive
Gambling

Nebraska Health and Human
Services System, Office of Mental
Health, Substance Abuse and
Addiction Services: Gamblers
Assistance Program

Oklahoma Association for
Problem & Compulsive Gambling,
Inc.

Oklahoma Dept. of Mental Health
& Substance Abuse Service

Mid-America Addiction
Technology Transfer Center
(MATTC)

Prairielands Addiction Technology
Transfer Center (PATTC)

June 8, 2007

The Midwest Consortium on Problem Gambling and Substance Abuse welcomes you to Kansas City, Missouri, and the 21st Annual Conference on Problem Gambling Prevention, Research, Recovery and Treatment: *Improving Practice and Managing Consequences for Problem Gambling, Substance Abuse, and Co-occurring Disorders*. We are pleased to collaborate with the National Council on Problem Gambling, the Missouri Alliance to Curb Problem Gambling, and the Missouri Council on Problem Gambling Concerns, Inc. in bringing national training and networking opportunity to the Midwest.

We recognize the importance in providing conference opportunities focused on problem gambling and substance abuse research, public policy, industry, treatment, and prevention to the Midwest and appreciate your support in our efforts. As you develop your career throughout the next three days, we believe that you will enjoy and find value in the presentations and networking opportunities. Please feel free to actively participate in the presentation discussions. Your thoughts will help to guide our ever changing field.

Midwest Consortium members are currently in the planning process for 2008 and will continue to provide training and networking opportunities to you on an annual basis. We invite you to join us August 13-15, 2008, in Missouri, and we invite you to communicate with us through our conference Web site which is hosted at www.888betsoff.org. We look forward to our continued correspondence with you as we work towards our shared goal of enhancing best practice knowledge to improve services for those who battle addiction.

On behalf of the Midwest Consortium on Problem Gambling and Substance Abuse – representing Iowa, Kansas, Missouri, Nebraska, and Oklahoma – we extend a warm welcome to the 2007 National Conference.

Anne Helene Skinstad, PhD
Candace Peters, MA, CADC
Martin Goransson, MPH
Kate Speck, PhD, MAC, LADC
Prairielands Addiction Technology Transfer Center

www.888betsoff.org/links/midwest_conference.shtm

Missouri Council on Problem Gambling Concerns, Inc.
5128 Brookside Boulevard
Kansas City, Missouri 64112-2736

Welcome to Kansas City!

The Missouri Council on Problem Gambling Concerns is proud to co-host the 2007 National Conference on Problem Gambling Prevention, Research, Recovery and Treatment. The conference committee, staff and a wide variety of supporters have worked hard to ensure that you will have a positive conference experience and visit to our city and state.

The 21st Annual Conference is the result of much collaboration among a diverse group of individuals concerned about problem gambling. It represents a significant level of support from our federal partners at the Substance Abuse and Mental Services Administration and the Center for Substance Abuse Treatment. We are particularly grateful for both the monetary support and leadership of our friend, H. Westley Clark. His leadership has and will continue to play a significant role in making the lives of problem gamblers and their families better.

The members of the Missouri Council on Problem Gambling Concerns and the Missouri Alliance to Curb Problem Gambling have a long history of working together to provide a safety net for persons affected by gaming of all kinds. In the last several years, those efforts have combined with those from Iowa, Nebraska, Kansas and Oklahoma to put on the Midwest Conference on Problem Gambling. We will do so again in 2008. However this year, we proudly threw our hats in with the National Council on Problem Gambling to combine our efforts into what we hope will be one of the best national conferences on problem gambling to date.

Today is an exciting time in history to be a part of this important event and movement toward a standard of care and standard of response to problem gambling throughout the United States and even beyond. I have worked in the field of substance abuse for more than 30 years and have been involved with compulsive gambling programming for more than 10 years. I remember what the early years for addiction treatment were like and the gains that have been made through hard-won experience, laborious research and endless networking and advocacy. I have seen the results in the substance abuse field and know that the same efforts in the problem gambling arena will bear fruit.

Your presence here gives witness to your commitment to advance your own knowledge and keep abreast of the field. Your participation will benefit the other participants as you share your knowledge and passion. While you are here, I strongly invite you to take heart a motto which a friend of mine had over his door "It is fitting and proper to have a good time in this place." Interact and mingle with the conference participants and get out and see Kansas City. We have great food, excellent shopping, and a world class museum with a new modern wing that in itself is a mammoth art form you will never forget. There are gardens and parks and fountains that will both dance for you, and in which you can dance...if that is your heart's desire.

Finally, even if you weren't planning to do so, consider joining us Friday night for the social event in the Jazz district. Did someone say spare ribs? I guarantee you, "A good time will be had by all!"

Let any of us know if there is anything we can do to increase the pleasure of your visit. We are thoroughly delighted to have you with us at this time and in this place have a big helping of Midwestern Hospitality— it's on the house.

Keith Spare
Chair, Missouri Council on Problem Gambling Concerns
Chair, Missouri Alliance to Curb Problem Gambling



*Welcome to the 21st Annual Conference on Problem Gambling
Prevention, Research, Recovery, & Treatment*

Conference Tips

- ☞ **Workshops** are designed for people with a wide range of involvement in providing services for clients with gambling problems and/or substance abuse concerns. Participants include clinicians, researchers, public policy makers, industry, law enforcement, and those in recovery, as well as their family members.
 - **Participants are responsible for picking up their Continuing Education Units (CEU) certificate from the designated area PRIOR TO LEAVING the conference.**
- ☞ **Message Board**, located at the Conference Registration Desk, is available for posting and checking messages.
- ☞ **Meals and snack breaks** are served only at the times noted in the agenda.
 - **Welcome Reception** on June 7 includes coffees, tea, hot and cold hor d'oeuvres.
 - **Continental breakfast** on June 8-10 includes seasonal fresh fruit, assorted breakfast pastries, muffins, breads, coffees, teas, and chilled juices.
 - **Morning breaks:** Coffee, soft drinks, bottled waters, and fruit juices.
 - **Afternoon snack breaks:** Assorted freshly baked cookies, whole fruit, individual bags of snack crackers, soft drinks, mineral waters, juices, teas, and coffee.
 - **Plated lunch – Friday, June 8:** Moroccan Orange Salad; Rolls, Roasted Balsamic Chicken, Chef's Selection of Potato/Pasta/Rice, Seasonal Vegetables; and Chocolate Meringue Pie.
 - **Plated lunch – Saturday, June 9:** House Salad, Rolls, Sesame Seared Pork Loin, Chef's Selection of Potato/Pasta/Rice, Seasonal Vegetables; and New York Style Cheesecake.
 - **Vegetarian and other special diet meals** are available – please sign up at the Registration Desk, so that we can inform the caterer of the quantity needed.
 - **Evening meals** are the responsibility of the participant. Be sure to check out the opportunity to enjoy the optional Kansas City Style barbecue & Museum Reception on Friday evening (see page 8, or the registration desk for details).
 - **Meals and snack breaks provide an excellent opportunity to network** with participants from your own state, as well as from other states.
- ☞ **Sessions may be videotaped and/or audiotaped.** If you wish to minimize your presence on videotaped sessions, please sit near the rear of the room.
 - These tapes may be available for a nominal charge.
- ☞ **We value your opinion!** Please share your suggestions and comments as to how we can better serve your professional needs with this conference on the evaluation forms.
- ☞ **We appreciate your assistance in conserving natural and fiscal resources.** Please return your name badge holder to the registration desk at the conclusion of the conference.
- ☞ **If you have any questions or require assistance**, please go to the registration desk, located on the 2nd Floor.
 - **Conference Committee and Staff** can also be identified by the ribbons on their name badges.

Hotel Information: Kansas City Downtown Marriott

Floor Maps for conference events

MARRIOTT TOWER

Keynote Addresses;
Lunches; and,
(Sunday only) Rooms
for Sessions E & F

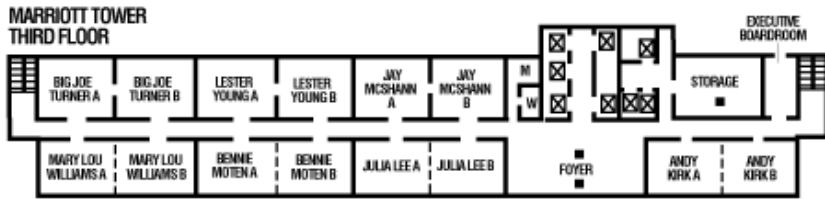
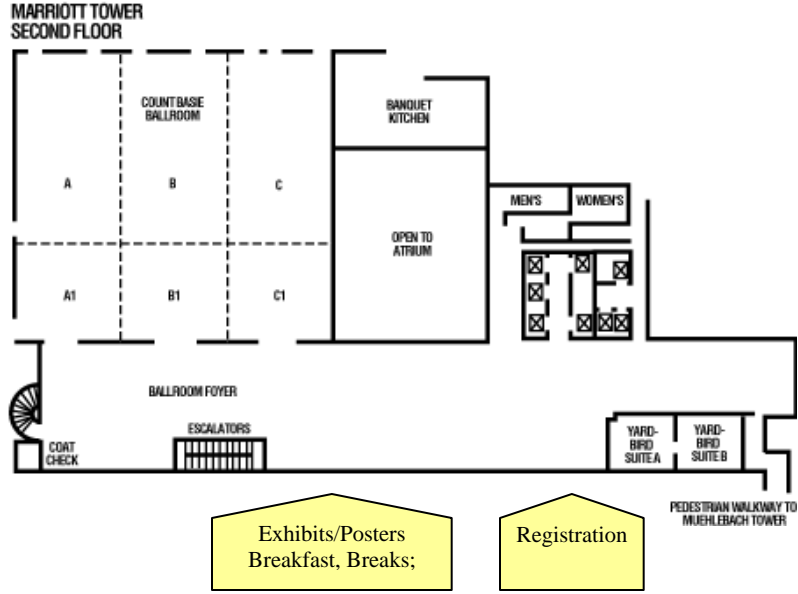

Rooms for Concurrent
Sessions A, B, C, & D
(Friday - Sunday).

Points of Interest

- Country Club Plaza shopping, theater/entertainment district
- Crown Center, 80+ shops and restaurants, two live theaters, movie theater, and ice skating
- Hallmark Cards international headquarters, featuring Kaleidoscope and Hallmark Visitors Center
- Science City / Union Station / Liberty Memorial
- 18th & Vine Historical District
- Nelson-Atkins Art Museum
- Negro Leagues Baseball Museum
- Truman Sports Complex
- Kansas City Zoological Park
- American Jazz Museum
- Riverboat Casino Complexes
- IMAX Theatre

Restaurants and Lounges

- Lilly's Restaurant (breakfast, lunch, & dinner)
- Pam-Pam Restaurant (breakfast; lunch)
- 12th Street Lounge (light dinner fare)

MUEHLEBACH TOWER

(can be accessed via the Pedestrian Walkway on the Second Floor of the Marriott Tower).

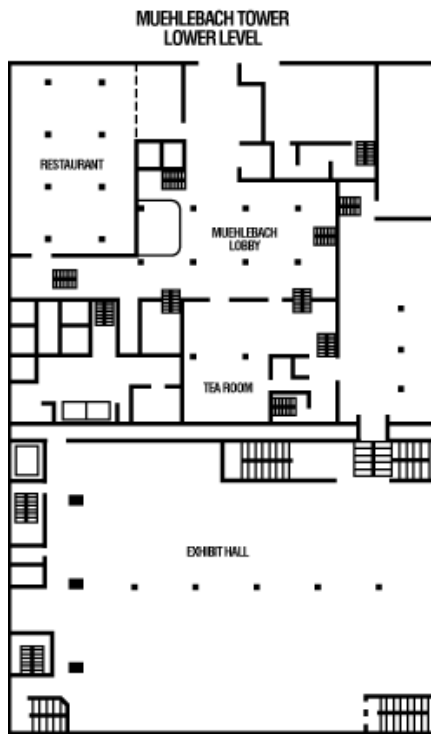

Welcome Reception & Pre-Registration on Thursday, June 7
(Barney Allis Lobby / Muehlebach Lobby)

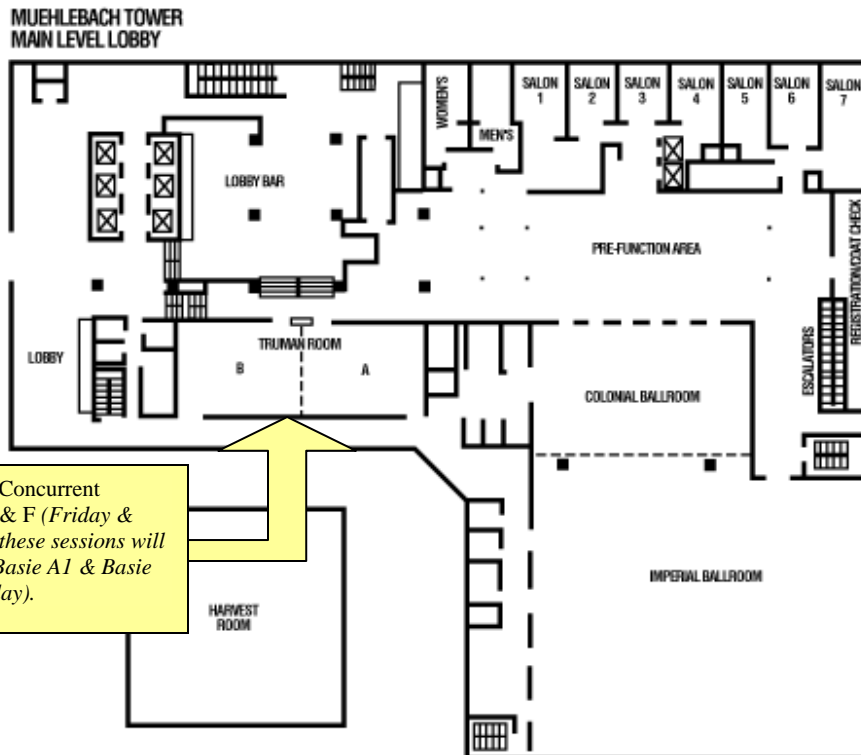

Rooms for Concurrent Sessions E & F (Friday & Saturday);- these sessions will be held in Basie A1 & Basie B1 on Sunday).

Professional Conference Etiquette

Be Patient - With approximately 500+ participants expected in attendance, there may/will be waiting. Please be patient and gracious to all of the volunteers and staff who are working hard to make this an excellent conference. We welcome your suggestions.

Be on Time - Please arrive to all sessions on time. It is difficult for both the presenters and the participants if participants interrupt by arriving late or leaving early

Turn off Cell Phones - Please be respectful of all speakers (and participants) by turning off cell phones.

Take Only One Set of Handouts - Please be considerate and take only one set of handouts. The presiders/recorders in each session will assist with the dissemination of any handouts that are not included in the conference booklet. All attending participants should have the handouts available. Any extra handouts remaining at the end of the session will be made available.

Be Kind to One Another and Assist New Counselors and Professionals to the Field - We are attending this conference for rejuvenation, relaxation, and recreation. Help others, including the new counselors/professionals, by exhibiting patience, understanding, and enthusiasm.

Adopt the “2-2-2” Conference Attitude - Make two new friends, reacquaint yourself with two old friends, and find two new ideas to take back with you to implement into your program. With this approach, you will leave feeling professionally and personally refreshed.

Don't Miss The Food & Fun on Friday Night!

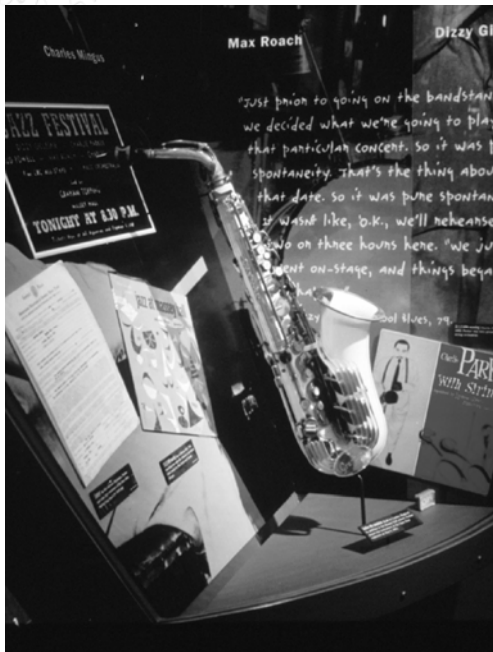

All conference attendees and their guests are invited to come and enjoy an evening out in true Kansas City style, with barbecue, jazz, and baseball! We will also honor the NCPG on their 35th anniversary, and the Missouri Alliance on their 10th anniversary.

This optional evening event includes:

- Kansas City's famous Gates barbeque, including pork ribs, chicken, beef, ham, turkey, and all the trimmings;
- Full access to the American Jazz Museum;
- Full access to the Negro Leagues Baseball Museum;
- Live jazz music in a twilight outdoor concert with the beautiful Kansas city skyline as a backdrop; and
- More!

Tickets are required – if you haven't already purchased your ticket, a limited supply is available at the registration desk for the on-site price of \$50.

Roundtrip transportation is provided – buses will leave the Downtown Marriott (and the museum complex) every 15 minutes from 6-7 p.m., and every 30 minutes from 7-10 p.m.

Snapshot View of Conference Agenda

Early Registration – June 7, 2007, Thursday

- 6:00 - 9:00 p.m. Early Registration
- 6:00 - 9:00 p.m. Welcome Reception

Day One – June 8, 2007, Friday

- 7:30 a.m. Registration
- 7:30 a.m. Exhibit Hall open
- 7:30 a.m. Continental Breakfast
- 8:30 a.m. Welcome;
Keynote Address: Anne M. Herron, M.S., CRC, CASAC, NCAC-II
- 10:00 a.m. Networking Opportunity, Poster Session, & Snack Break
- 10:30 a.m. Concurrent Sessions
- 12:00 p.m. Lunch & Keynote Address: Keith Whyte
- 1:30 p.m. Concurrent Sessions
- 3:00 p.m. Networking Opportunity, Poster Session, & Snack Break
- 3:30 p.m. Keynote Address: Thomas E. Freese, Ph.D.
- 5:00 p.m. Close for the Day
- 6:00 -10:00 p.m. Kansas City Barbecue & Museum Reception

Day Two – June 9, 2007, Saturday

- 7:30 a.m. Registration
- 7:30 a.m. Exhibit Hall open
- 7:30 a.m. Continental Breakfast
- 8:30 a.m. Welcome;
Keynote Address: Jon Grant, M.D., J.D., M.P.H.
- 10:00 a.m. Break
- 10:15 a.m. Concurrent Sessions
- 12:00 p.m. Awards Lunch & Presentation
- 1:00 p.m. Networking Opportunity
- 1:30 p.m. Concurrent Sessions
- 3:00 p.m. Break
- 3:30 p.m. Keynote Address: Ken Winters, Ph.D.
- 5:00 p.m. Close for the Day
- 5:00 p.m. GA Meeting
- 5:00 p.m. AA Meeting
- 5:00 p.m. NA Meeting

Day Three – June 10, 2007, Sunday

- 7:30 a.m. Registration
- 7:30 a.m. Exhibit Hall open
- 7:30 a.m. Continental Breakfast
- 8:30 a.m. Concurrent Sessions
- 10:00 a.m. Networking Opportunity, Poster Session, & Snack Break
- 10:30 a.m. Concurrent Sessions
- 12:00 p.m. Close of Conference

Conference Schedule

Thursday, June 7 (Pre-Conference)

6:00 – 9:00 p.m.	Early Registration; Welcome Reception	Barney Allis Lobby, <i>Muehlebach Tower</i>
------------------	--	--

Friday, June 8 ~ Day One

7:30 a.m.–5:00 p.m.	Registration	Ballroom Foyer; 2 nd Floor <i>Marriott Tower</i>
7:30 a.m.–5:00 p.m.	People’s Choice Award for Print Campaigns Viewing and Voting	Ballroom Foyer; 2 nd Floor <i>Marriott Tower</i>
7:30 a.m.–5:30 p.m.	Exhibits	Ballroom Foyer; 2 nd Floor <i>Marriott Tower</i>
7:30 – 8:30 a.m.	Continental Breakfast	Ballroom Foyer; 2 nd Floor <i>Marriott Tower</i>
8:30 – 10:00 a.m.	Conference Welcome Morning Keynote: 1A ~ <i>Addiction and Problem Gambling: The State of the State’s Involvement</i>	Basie Ballroom; 2 nd Floor <i>Marriott Tower</i> **will be videotaped
10:00 – 10:30 a.m.	Networking Break & Poster Session ~ Snacks available in exhibit hall 2A ~ <i>Problem Gambling: Preliminary Results from KC-MO-GAM Household Study of Youth</i> This presentation will provide preliminary results of the first Missouri household study of gambling and disordered gambling among youth. We will present epidemiologic data on gambling, DSM-IV problem and pathological gambling disorder for 351 youth ages 14-25 (48% female;14% minority) selected from listed Missouri households. Where statistically appropriate, we will further describe prevalence rates using poststratification weighting and in the context of socio-demographic characteristics, and co-occurring depression and substance use. These data may inform clinicians and others working with youth in the areas of problem gambling prevention and intervention.	Ballroom Foyer; 2 nd Floor <i>Marriott Tower</i>
	Renee Cunningham-Williams, Ph.D., M.P.E., LCSW.	
	Carolyn Hawley, Ph.D.	
	2B ~ <i>Characteristics of Employees with Self-Reported Gambling Problems Seeking Help</i> This study explores the vocational patterns and demographics of employed individuals seeking help for self-reported gambling related problems. It utilizes Chi-squared Automatic Interaction (CHAID) Technique analysis to assess 1072 working age individuals with gambling related problems. The goal of the exploratory investigation is to determine if the issue of problem gambling in the workplace warrants further research and, potentially, design of interventions. Discussion centers on the use of the information for development of employer-based prevention and intervention efforts.	
	Susan D. McLaughlin, M.P.A., CPP-R	
	2C-A <i>Statewide Collaborative Approach to Planning and Implementing School Based Problem Gambling Prevention Programs</i> Building upon a history of supporting community-based problem gambling prevention programs for youth, Connecticut has embarked upon a unique collaboration which includes the State Departments of Education and Mental Health and Addiction Services and state-funded networks of community-based prevention programs and regional education service centers. This collaboration has gathered data on school readiness and student gambling behaviors, conducted a statewide teacher training initiative, offered a series of local parent awareness meetings, and nurtured pilot projects which build upon the peer-to-peer and youth-to-adult teaching model. Also under development is a 10-session intervention program for identified at-risk youth.	

10:30 a.m. – noon	Concurrent Sessions	Mary Lou Williams; 3 rd Floor, <i>Marriott Tower</i>
Gene Lutz, Ph.D. Mark VanderLinden, M.S.W.	3A ~ Useful Problem Gambling Treatment Outcomes Monitoring The presenters will discuss the development of the Iowa Gambling Treatment Outcomes monitoring system, including the scientific and practical considerations that determine its evolution. Emphases are given to the varied purposes for the system, the complexities of its implementation, and the uses to which it is intended.	
Paula Burns, M.A. Michelle Neitch, B.S.	3B ~ Substance Abuse and Gambling Among Arizona Youth: Results of the Risk and Protective Survey 2006 The 2006 Arizona Youth Survey conducted by the Arizona Criminal Justice Commission surveyed 8 th , 10 th , and 12 th graders across the state of Arizona on issues relating to substance use, risk and protective factors, delinquency, and other problem behaviors including gambling. 45,920 students answered the gambling questions. The results support earlier findings from other states' surveys that show youth who participate in gambling activities are far more likely to be demonstrating a wide spectrum of problem behaviors. While the survey results do not show that gambling causes these other risk behaviors, it adds to the growing data that may be used as a tool for building a strategic prevention framework. The data reveal correlations between youth gambling and substance use, elevated risk factors for future substance abuse, and higher rates of other anti-social behaviors such as being suspended from school or being arrested. Frequent gamblers also reported fewer protective factors (conditions that decrease the likelihood of future behavior problems) than youth reporting no gambling behavior.	Bennie Moten; 3 rd Floor <i>Marriott Tower</i>
Pat Stilen, LCSW, CADAC.	3C ~ Treatment Planning M.A.T.R.S.: Utilizing the ASI to Individualize Client Plans This 90-minute presentation seeks to "marry" the process of assessment and treatment planning and to help providers transform required "paperwork" into clinically useful information. Training materials and teaching tools demonstrated are designed for addiction counselors, clinical supervisors, program managers or anyone who completes assessments or treatment plans regardless of assessment tools or formats used in practice.	Julia Lea; 3 rd Floor <i>Marriott Tower</i> <i>**will be videotaped</i>
Thomas E. Freese, Ph.D.	3D ~ Buprenorphine: A New Approach to Opioid Treatment The goal of the workshop is to create awareness about buprenorphine among multidisciplinary addiction professionals. The materials are designed to increase motivation for bringing buprenorphine to local communities, as well as information about what to expect when someone is treated with this medication. Additionally, materials discuss legislation that permits office-based buprenorphine treatment, information about opioid dependence, an overview of buprenorphine and its use, patient selection issues, and strategies for providing counseling to patients receiving buprenorphine.	Andy Kirk; 3 rd Floor <i>Marriott Tower</i> <i>**will be videotaped</i>
Norman Richardson, B.S. Cynthia Payne, M.A.	3E ~ The Gaming Industry's Commitment to Responsible Gaming Gaming operators have provided employee and public education programs to increase awareness of problem gambling and promote responsible gaming practices within their facilities for many years. In addition to the self imposed procedures most states have specific requirements that casino operators must offer assistance to problem gamblers, which include a mandate for casino operators to offer guests who request assistance referral assistance to health care professionals and processes for these guests to disassociate or self-exclude from the casino. This session is intended to provide a better understanding of the gaming industry's commitment toward assisting guests and team members who suffer from problem gambling.	Truman A; Main Level <i>Muehlebach Tower</i>
Don Feeney, M.S., M.P.P.	3F ~ Graphic Revelations: Effective Communications Through Statistical Graphics Graphics have become an almost inescapable feature of any presentation of information to an audience. But not every graphic is worth the proverbial thousand words. In this presentation you'll see examples of good and bad graphical presentations, and you'll learn how to tell the difference. We'll discuss the pros and cons of the most commonly used graphics (like pie charts), show some examples of less conventional displays, and explore the details that can make one bar chart sing while the other stands tongue-tied.	Truman B; Main Level <i>Muehlebach Tower</i>

<p>Noon – 1:30 p.m. Keith Whyte</p>	<p>Lunch Keynote: 4A ~ Future Issues in Gambling and Problem Gambling What are the trends in gambling and problem gambling over the next five to ten years? Keith Whyte provides a provocative discussion of a number of areas and issues that will change the way we think about gambling and how we respond to gambling problems.</p>	<p>Basie Ballroom; 2nd Floor Marriott Tower</p>
<p>1:30 – 3:00 p.m. Brian H. Farr, M.A., LPC, NCGC-II</p>	<p>Concurrent Sessions 5A-1 ~ Money: Therapeutic Strategies for Gambling Treatment This presentation provides an overview of the role and meaning of money in contemporary culture; explores common resistance experienced by mental health counselors when addressing client financial issues; discusses the impact of money on the values, self-concept and sense of safety of the clients; and provides therapeutic tools that stimulate healthy change in the financial behaviors of gambling treatment clients. Participants will receive materials and exercises for use in personal development, individual clinical sessions and client groups.</p>	<p>Mary Lou Williams; 3rd Floor, Marriott Tower</p>
<p>Alberto Duarte, M.P.A. Pat Fowler</p>	<p>5A-2 ~ Financial Distress and Problem Gambling Go Hand in Hand Until recently, problem gamblers have had little access to professional financial counselors who understand their special needs. FCCG has partnered with InCharge Institute of America to pilot a financial counseling and education program specifically designed for problem and compulsive gamblers. Presentation will include discussion on the pilot program, as well as review of additional research by InCharge and FCCG.</p>	
<p>Benton Granville, M.A.</p>	<p>5B ~ Addictions and Family Violence: A Collaborative Approach This presentation will be done via PowerPoint but will also include audience participation and interaction. Much of the focus of the presentation will be on how to better foster collaboration between people who work in the addiction field and people who work in domestic violence fields. They traditionally have not worked well together despite considerable overlap in client populations. This presentation will show how these two fields can learn much from each other and benefit from each other's expertise which will pave the way for a more coordinated system of care. The presentation will also show how some clients will misinterpret the 12-step philosophy to justify their continued violence against family members.</p>	<p>Bennie Moten; 3rd Floor Marriott Tower</p>
<p>Tim Fong, M.D.</p>	<p>5C ~ Is Problem Gambling Neurotoxic? This workshop will present data showing that problem gamblers demonstrate impairments in neurological functioning. The level of dysfunction seen in problem gamblers is similar to that seen in patients with methamphetamine dependence. We will then describe how these neurocognitive impairments can affect treatment outcomes and retention.</p>	<p>Julia Lea; 3rd Floor Marriott Tower <i>**will be videotaped</i></p>
<p>Barbara Porto, B.A. Brian Rockey, M.P.A., M.P.S. Don Feeney, M.S., M.P.P. Moderator: Gary Gonder, M.P.A.</p>	<p>5D ~ Panel Discussion ~ Best Practices for Lottery Problem Gambling Programs This will be a panel discussion to provide an exchange of ideas and comments among the panel members, as well as workshop attendees. While some discussion points may be planned, such as improving public awareness and self-excluded persons programs, the moderated panel will provide a forum for discussion on a variety of topics related to the industry's role in problem gambling awareness.</p>	<p>Andy Kirk; 3rd Floor Marriott Tower <i>**will be videotaped</i></p>
<p>Anne Helene Skinstad, Ph.D. Candace Peters, M.A. CDC</p>	<p>5E ~ Clinical Supervision: An Art of the Past or the Future? The presentation will focus on: (1) a national workforce picture, (2) leadership strategic planning, and (3) empirically supported models for clinical supervision as it applies to counseling with reference to the 2006 TAP21 (<i>Technical Assistance Publication #21: Addiction Counseling Competencies: The Knowledge Skills and Attitudes of Professional Practice</i>), and (4) the implementation of evidence-based practices. A working definition of clinical supervision will be provided including both administrative and clinical functions, and highlighting the utility of the counselor developmental model.</p>	<p>Truman A; Main Level Muehlebach Tower</p>

Brian Herder	<p>5F-1 ~ "Beat the Bet": Designing a College Gambling Campaign You've got the basics down cold - when to hold, fold, bluff, double down, buy insurance, max lines and split the aces. But do you know the answers to the most important questions a gambler faces? Compulsive gambling is a hot topic today - particularly on college campuses where experts say students are three times more likely than adults to develop a behavioral disorder from recreational gaming. The State of Minnesota's Problem Gambling Program recently launched an awareness effort designed to connect those in need with qualified treatment resources. Learn about gambling's impact among young adults as well as effective ways of sharing counseling related information with college students.</p>	Truman B; Main Level <i>Muehlebach Tower</i>
<p>Jeffrey J. Marotta, Ph.D. Eric N. Alexander, Ph.D.</p>	<p>5F-2 ~ Gambling on Campus: Addressing Risks and Realities This workshop will address gambling on campus by providing an overview of the literature on college aged gambling, why it should be of concern to colleges, how it can affect students, and what can be done to prevent or treat problem gambling among students. The presentation will include a description of a statewide program targeting private and public two- and four-year colleges and use the efforts at Oregon State University as an example of specific activities and outcomes related to addressing gambling on campus. The workshop will incorporate a multi-media presentation, group discussion, and handouts with the objective to empower participants to replicate and expand on existing efforts to minimize harm caused by gambling among college aged youth.</p>	
3:00 – 3:30 p.m.	<p>Networking Break & Poster Session ~ Snacks available in exhibit hall</p>	Ballroom Foyer; 2 nd Floor <i>Marriott Tower</i>
<p>Harlan H. Vogel, MS, NCGC, CCGC, LPC</p>	<p>6A ~ Treatment Protocol for the Integrated Treatment of Clients Diagnosed as Pathological Gamblers Dual (or more) diagnosis is the "usual", not the exception. It is common enough that it is important to screen and assess for co-morbid conditions when assessing for a pathological gambling diagnosis. If a mental health problem or a substance disorder co-exists with a pathological gambling disorder, both diagnoses should be considered primary, and both should be treated simultaneously rather than serially. A substance disorder or psychiatric disorder should be considered, "secondary", only if it resolves when the pathological gambling disorder is at baseline. This protocol describes a process by which to organize a treatment process to effectively identify and treat pathological gambling as dually diagnosed or multi-problem clients, and how to for a mental, emotional, or relational disorder; as well as other addictive problems such as alcohol abuse or substance abuse.</p>	
Jessica McBride	<p>6B ~ Youth Gambling and the Internet: A Preliminary Examination The online gambling industry is a multi-billion dollar industry that continues to grow despite recent attempts in the United States to ban it. Items abound in the popular press concerning the serious negative consequences of gambling on the Internet for some individuals, yet there is no clear cut evidence on how wide spread or how problematic Internet gambling is. This presentation will review recent research concerning the gambling behavior of college and university students with a focus on Internet gambling. The implications of the popularity and proliferation on online gambling sites for the development of problem gambling behavior among college age students will be discussed.</p>	
<p>Kate Speck, Ph.D., MAC, LADC</p>	<p>6C ~ Listening to Their Voices Will describe the results of statewide focus groups regarding Nebraska's Children's Mental Health and Substance Abuse services and provide recommendations. Statewide focus groups were held in each of the state's six behavioral health regions resulting in steering committee recommendations which were accepted for implementation.</p>	
3:30 – 5:00 p.m.	<p>Afternoon Keynote 7A ~ Methamphetamine and the Brain: Implications for Behavior and Thought This presentation will provide an overview of issues related to methamphetamine including its impact on the brain and associated changes in neurocognitive functioning. Additionally, psychiatric and medical consequences of ongoing use will be explored. Recommendations for ways to address client needs based on these changes will be made.</p>	Basie Ballroom; 2 nd Floor <i>Marriott Tower</i> <i>**will be videotaped</i>
<p>Thomas E. Freese, Ph.D.</p>		

5:00 p.m.	Turn In Evaluations	Registration Desk
6:00 - 10:00 p.m.	Kansas City Barbecue & Museum Reception ~ <i>NCPG's 35th Anniversary Celebration;</i> ~ <i>Missouri Alliance's 10th Anniversary Celebration</i> @ the American Jazz Museum/Negro Baseball Leagues Museum (tickets are required) ~ see additional details on page 8. <i>Buses will depart (and return to) the Marriott every 15 minutes from 6-7 p.m., and every 30 minutes from 7-10 p.m.</i>	Meet in the lobby of the Marriott Tower

Saturday, June 9 ~ Day Two

7:30 a.m.–5:00 p.m.	Registration	Ballroom Foyer; 2 nd Floor Marriott Tower
7:30 – 11:00 a.m.	People's Choice Award for Print Campaigns Viewing and Voting	Ballroom Foyer; 2 nd Floor Marriott Tower
7:30 a.m.–5:30 p.m.	Exhibits	Ballroom Foyer; 2 nd Floor Marriott Tower
7:30 – 8:30 a.m.	Continental Breakfast	Ballroom Foyer; 2 nd Floor Marriott Tower
8:30 – 10:00 a.m. Jon Grant, M.D., J.D., M.P.H.	Welcome Morning Keynote: 8A ~ Problem Gambling and Substance Abuse Best Practices: Pharmacology and Cravings	Basie Ballroom; 2 nd Floor Marriott Tower **will be videotaped
10:00 – 10:30 am David Carter, Ph.D.	Networking Break & Poster Session ~ Snacks available in exhibit hall 9A ~ AA + GA + TA = Relapse Prevention & Empowerment Model Participants will increase their knowledge of life situations that promote feelings of powerlessness and possible relapse for individuals recovering from chemical and gambling issues. This poster focuses on the issue of powerlessness and empowerment as described in AA, GA, and TA and a therapeutic model is presented that bridges the steps and therapy techniques for enhanced recovery. 9B ~ Youth Voices: Gambling Expression and Action Through Media Technologies Youth Voices, based at the University of Toronto, is an applied education/prevention/research project which uses media technologies for youth expression and action on community health issues. We have developed a model for community-based participatory research, EIPARS, which describes a six-phase process; Engage, Identify, Plan, Act, Reflect/Research/Reward and Sustain.	Ballroom Foyer; 2 nd Floor Marriott Tower
Clark Kopelman B.A.	9C ~ The Application of Social Learning Theory to Gender Differences in Undergraduate Binge Drinking National surveys have found that approximately 40 percent of undergraduate students binge drink, though existing studies haven't adequately identified factors associated with the higher prevalence of bingeing among males. The current study uses data from the 2001 College Alcohol Survey, a cross-sectional survey used at 140 undergraduate institutions in the United States, and asks what components of social learning theory are associated with bingeing for male and female undergraduate students? Overall, the study extends previous knowledge by highlighting the need to focus on factors associated with bingeing for both males and females.	

10:30 a.m. – noon	Concurrent Sessions	
Jennifer Shatley, M.S.	10A ~ Harrah's Responsible Gaming Training: Development and Evaluation Description not available at time of printing	Mary Lou Williams; 3 rd Floor, Marriott Tower
Joan Masters, M.Ed. Kristy Wanner, M.Ed.	10B ~ Rolling the Dice: Gambling with College Life. Examining a State's College Problem Gambling and Substance Abuse Prevention Programs Some college students and young adults often engage in risky behaviors such as problematic gambling, drinking and drug use. Often times, the prevention practitioners who work with this population feel alone in the fight against these behaviors. Statewide coalitions are a valuable resource for prevention professionals and administrators working in communities or on college campuses to network and program collaboration. Partners in Prevention (PIP) is a statewide coalition in Missouri focused on the prevention of high-risk drinking among Missouri's college students. This session is designed to help participants understand the higher education prevention framework, investigate creating partnerships for systemic change, and learn about how a statewide or community-wide prevention coalition can be used as an effective prevention tool.	Bennie Moten; 3 rd Floor Marriott Tower
Jeffrey Derevensky, Ph.D. Rina Gupta, Ph.D.	10C ~ Preventing Youth Gambling Problems: An Examination of Some New Initiatives This workshop will briefly examine the phenomenon of youth gambling and take a science, evidence-based approach to discussing prevention efforts. Some of the curriculum, workshops and DVD materials currently available to help prevent gambling problems by incorporating a harm minimization approach will be examined. In particular, the prevention initiatives developed at the International Centre for Youth Gambling Problems and High-Risk Behaviors will be presented. The scientific prerequisites for modifying inappropriate gambling behaviors will be addressed.	Julia Lea; 3 rd Floor Marriott Tower **will be videotaped
Rena Nora, M.D.	10D ~ Cultural Competency in Clinical Supervision Cultural competence refers to the capacity of the service provider or of an organization to understand and work effectively with the cultural beliefs, and practices of persons from a given ethnic or racial group. The multicultural perspective is essential in all aspects of counseling and education. Several of our most populous states containing half of the nation's young people will have significant minority populations. The supervision triad of client, student or counselor and supervisor will most likely contain persons of different ethnic backgrounds dealing with problems in a diverse social environment. The presentation will focus on the elements of cultural competence, which is more of an approach than a technique. Cultural factors that may have impact on diagnosis and treatment of clients with addictions include: heritage, history and experience, beliefs, traditions, values, customs, behaviors, institutions, and ways of communicating. Cultural characteristics of ethnic minorities will be discussed in terms of demographics, risk factors, diagnostic factors, best-studied culture bound syndromes, idioms of expression and intervention. Barriers to treatment of ethnic minority groups will be outlined, as well as "doorway thoughts" in dealing and communicating with ethnic minorities.	Andy Kirk; 3 rd Floor Marriott Tower **will be videotaped
R. Kent Dean, Ph.D.	10E ~ Practicum in Teaching Relapse Prevention Skills for Patients We will examine how emotions and behavior are influenced by environmental cues and by craving, and we will practice specific strategies for coaching patients on how to fall back on practiced behaviors that can prevent relapse in the midst of a craving episode.	Truman A; Main Level Muehlebach Tower
Tim Christensen, M.P.A. Dean Hestermann, M.A.. Jeffrey Marotta, Ph.D. Moderator: Keith Whyte	10F ~ Panel Discussion ~ Casino Gambling Comes to Kansas: Politics, Profits, and Problem Gambling Is the recent expansion of gambling in Kansas in line with or a departure from recent national trends? Is Kansas addressing problem gambling services appropriately? What are the implications of state-owned casinos? Will the expansion of gambling have a "domino effect" that pressures other states in the region to expand their operations to compete with Kansas? This moderated roundtable will provide an overview of the situation in Kansas and explore these issues in greater detail.	Truman B; Main Level Muehlebach Tower

Noon – 1:30 p.m. Michael Smith, Ph.D.	11A ~ Awards Lunch & Presentation	Basie Ballroom; 2 nd Floor Marriott Tower
1:30 – 3:00 p.m. Silvia Martins, M.D., Ph.D. Joanna Franklin, M.S., NCGC-II	Concurrent Sessions 12A ~ Gender Differences in Adolescent Gambling in Inner-City Youth Participants will learn about gender differences in adolescent gambling and problem gambling in inner-city (predominantly African-American youth). They will understand the role of childhood externalizing behaviors in both male and female adolescent gambling and problem gambling, as well as the association of gambling and problem gambling with substance use and mental health problems in adolescence. The final part of the presentation will focus on Maryland's legislation towards gambling with a special focus on adolescent gambling and the role of Maryland's Council on Problem Gambling.	Mary Lou Williams; 3 rd Floor, Marriott Tower
Katherine M. Diskin, Ph.D.	Presentation by NCPG Student Dissertation Awardee 12B ~ Effects of a Single Session Motivational Intervention on Problem Gambling Behavior The effects of a single face-to-face motivational intervention (MI) were compared to those of an attention control interview (AC) in reducing gambling behavior over a 12-month period. Individuals experiencing concerns about gambling, who had gambled in the previous 2 months, were over 17 and who were not in treatment for gambling problems, were recruited through media advertisements. Participants were randomly assigned to receive either an MI or an AC interview. Participants (N = 81) in the two conditions did not differ significantly by age, gender, level of problem gambling, or by mean dollars, days or dollars gambled/day in the 2 months preceding the intervention. After participating in a face-to-face interview, participants were followed at 1, 3, 6 and 12 month intervals. They were asked to report days and dollars gambled for the preceding time periods. A third variable, dollars gambled per day, was calculated from days and dollars gambled.	Bennie Moten; 3 rd Floor Marriott Tower
Barbara Porto, B.A. Gloria Donnelly, B.S. Susan D. McLaughlin, M.P.A., CPP-R	12C ~ The Soft Approach to Problem Gambling Prevention The gaming industry walks a fine line between increasing revenue and promoting responsible gambling. The Connecticut Lottery Corporation tackled this dilemma head-on by creating a singularly unique and innovative employee problem gambling awareness program, which included employees, staff, retailers, vendors, and their partners in problem gambling treatment and prevention. This presentation will share what led to the development of this initiative, the logistical, agency, and personnel challenges, and the anecdotal and systematic data gathering and results, and short- and long-range goals to build upon this process. Panel presentation will include the viewing of media developed specifically for this initiative, inquiry from the audience on the adaptation of this model program, and group discussion.	Julia Lea; 3 rd Floor Marriott Tower <i>**will be videotaped</i>
Eric Hunsberger, M.S. Mark VanderLinden, M.S.W.	12D ~ Community Mobilization: Multi-state Collaboration of Problem Gambling Treatment, Training, and Prevention Strategies Our presentation will incorporate a wraparound approach within a community-based framework for the problem gambling community. Treatment providers will learn how strategies in urban and rural communities support their services of assessment, treatment, and after-care. Educators and professionals will learn how programs determine and link measurable and reliable outcomes to program development. Finally, attendees will understand the how to promote community ownership and how its one of the key factors to community mobilization in addressing the issues of problem gambling. Attendees of this presentation will be able to apply these elements within in their own communities and service (priority) populations. Overall this presentation will be a mini-workshop where information is exchanged and participants can visualize concept on a national scale.	Andy Kirk; 3 rd Floor Marriott Tower <i>**will be videotaped</i>
Dan Smith, M.A., ABD, LCSW, CCGC, NCGC	12E ~ Dismantling the Stigma of Recovery: Grief as an Impactful Therapeutic Process Participants will better understand the role of identification and grieving as an adaptable methodology with gamblers, substance abusers, and their families in recovery. Reducing stigma in recovery is a by-product of engaging in the grief process. Those unfamiliar with current palliative care models will (1) experience exercises readily adaptable to various therapeutic settings;	Truman A; Main Level Muehlebach Tower

- (2) examine loss, stages of grief, and palliative care techniques as stigma-reducing; and
- (3) review successful & unsuccessful grief work in addiction treatment settings.

<p>Marla A. Corwin, M.S.W., LCSW, CAC-III</p>	<p>12F ~ Methamphetamine, Alcohol, and HIV: Risks and Prevention in Native American Communities</p>	<p>Truman B; Main Level Muehlebach Tower</p>	
<p>Twenty-six years into the HIV epidemic, substance abuse remains paramount in the fueling spread of the virus. Increased methamphetamine use, along with alcohol use, contributes to higher rates of suicide, HIV, and hepatitis among American Indians. This presentation will examine the links between meth, alcohol, and HIV, as well as risk factors and prevention strategies for Native American communities.</p>	<p>3:00 – 3:30 p.m. Timothy A. Steenbergh, Ph.D.</p>	<p>Networking Break & Poster Session ~ Snacks available in exhibit hall</p>	<p>Ballroom Foyer; 2nd Floor Marriott Tower</p>
<p>13A ~ Labeling Practices of U.S. Lotteries While warning labels have been federally mandated for tobacco and alcohol products, individual states are responsible for determining what information must be provided to lottery consumers. Some have suggested that gambling products should provide consumers with sufficient information to make informed decisions and promote responsible gaming. Lottery ticket labeling can provide consumers with information on the risks of playing and the odds of winning, as well as help line numbers to assist problem gamblers. This presentation will include results from a study that examines the current labeling practices of 43 U.S. lotteries.</p>	<p>Mia Moran-Cooper, B.S.W., LSW.</p>	<p>13B ~ Almost Heaven...The Story of the West Virginia Recovery Weekend</p>	
<p>In August of 2006, staff from the Problem Gamblers Help Network of West Virginia hosted an intense weekend of recovery for problem gamblers and their loved ones. This groundbreaking event involved over 100 problem gamblers, loved ones of gamblers, and treatment professionals. We will discuss the surprising reaction to this event from our callers, and how we recruited participants. We will detail all aspects of the program's design and implementation. We will talk about emotional ups and downs of the weekend, including some of the lighter moments. Some of the best lessons came from unexpected challenges and we'll discuss how we handled these.. We will review the participants' and staff evaluations of the experience as well as follow-up data and outcomes.</p>	<p>Gina Fricke, M.S.W., LCSW, CCGC, NCGC-II</p>	<p>13C ~ Harm Reduction in Gambling Treatment or Addressing Precontemplation in Addicted Gamblers</p>	
<p>Therapeutically, harm reduction can be a fairly quick way for the addicted gambler to learn controlling their gambling is not possible. It works because the gambler sets the parameters for the gambling. Education and a verbal contract to attend weekly appointments for six months are utilized. Generally, the gambler is unable to maintain his or her parameters and discovers the gambling is out of control. Parameters include: amount of money, how often, how much time, planning the gambling in advance, being accountable to someone else by telling them the plan to go gambling, telling them the time he gambler will be finished and then the gambler calling the person after the gambling excursion.</p>	<p>3:30 – 5:00 p.m. Ken Winters, Ph.D.</p>	<p>Afternoon Keynote 14A ~ Developmental Perspectives on Youth, Gambling, and Substance Abuse</p>	<p>Basie Ballroom; 2nd Floor Marriott Tower **will be videotaped</p>
<p>5:00 p.m.</p>	<p>Turn In Evaluations</p>	<p>Registration Desk</p>	
<p>5:00 – 6:00 p.m.</p>	<p>GA Meeting (open meeting)</p>	<p>Julia Lea; 3rd Floor Marriott Tower</p>	
<p>5:00 – 6:00 p.m.</p>	<p>AA Meeting (open meeting)</p>	<p>Bennie Moten; 3rd Floor Marriott Tower</p>	
<p>5:00 – 6:00 p.m.</p>	<p>NA Meeting (open meeting)</p>	<p>Mary Lou Williams; 3rd Floor, Marriott Tower</p>	

Sunday, June 10 ~ Day Three

7:30 a.m. – noon.	Registration	Ballroom Foyer; 2 nd Floor <i>Marriott Tower</i>
7:30 – 10:30 a.m.	Exhibits	Ballroom Foyer; 2 nd Floor <i>Marriott Tower</i>
7:30 – 8:30 a.m.	Continental Breakfast	Ballroom Foyer; 2 nd Floor <i>Marriott Tower</i>
7:30 – 8:30 a.m.	NCPG Gaming Regulation Meeting (By Invitation Only)	Count Basie C1; 2 nd Floor <i>Marriott Tower</i>
8:30 – 10:00 a.m.	Concurrent Sessions	
Claude Boutin, M.P.S. Nicole Tremblay, Ph.D.	<p>15A-1 ~ Improved Responsible Gaming Strategies: Self-Exclusion and Onsite Casino Centre</p> <p>This presentation will provide the participant with the preliminary results associated with the implantation of an improved self-exclusion service. The presenters will discuss the importance of the voluntary and mandatory meetings that are integrated to this service. The second part of the presentation deals with a new Onsite Casino Centre: Le Centre du Hasard that is aimed at recreational gamblers. Preliminary results, purpose of the Centre and recommendations will be addressed. Difficulties of implanting those two exceptional services will be discussed as well.</p>	Mary Lou Williams; 3 rd Floor, <i>Marriott Tower</i>
Bill Davies, Ph.D.	<p>15A-2 ~ iCare: Integrating Responsible Gaming into Casino Operation</p> <p>The Saskatchewan Gaming Corporation has developed a new approach to responsible gaming that will enhance industry practices. The system incorporates a comprehensive new approach that incorporates responsible gaming into casino floor operations and ensures that responsible gaming becomes part of overall corporate direction. The iCare system has the ability to identify and track high-risk play in real time, to notify casino management of this play, and to track interventions. Combined with this ability to analyze player activity is a software system developed in partnership with iView Systems that links responsible gaming activities to other casino management systems. The final component of SGC's iCare environment is staff training, which clearly identifies how staff use both the software system and conventional sources of observation. The iCare system gives casinos the ability to collect and analyze empirical evidence related to levels of risk and risk patterns of players.</p>	
Joe Westermeyer, Ph.D.	<p>15B-1 ~ Demographics, Cultural, and Psychiatric Correlates of Gambling Among Native American Veterans</p> <p>This analysis was undertaken to assess the demographic and mental health characteristics of gamblers versus non-gamblers. Gamblers were more apt to be older, employed full-time, and ethnic Anishinabe. Gamblers also had more lifetime Mood, Anxiety, and Antisocial Personality Disorder. Education, marital status, lifetime Substance Use Disorder, and any mental health treatment since active military duty were not associated with lifetime gambling in the regression analysis. Gamblers showed greater social competence as a group (as manifested by employment status) but also manifested higher lifetime rates of the "internalizing" (mood and anxiety) psychiatric disorders and Antisocial Personality Disorder. Tribal membership was probably related to gambling through access to gambling venues.</p>	Bennie Moten; 3 rd Floor <i>Marriott Tower</i>
Duane Mackey, Ed.D.	15B-2 ~ Native American Culture and Treatment Effects	
Doug Walker, Ph.D.	<p>15C ~ The Missing Link Between Gambling Research and Policy: Cost-Benefit Analysis</p> <p>Policymakers rely on research on problem gambling behavior and the related social costs in order to develop policies for funding research and treating problem gambling. However, the link between diagnosis and treatment and policy is cost-benefit analysis. Studies that have attempted to quantify the costs and benefits of</p>	Julia Lea; 3 rd Floor <i>Marriott Tower</i> **will be videotaped

	<p>legalized gambling, as well as the treatment of problem gambling, have been plagued by researcher biases, lack of empirical data, and methodological flaws. The result has been uninformed policy decisions. This presentation highlights some of the most serious flaws in the cost-benefit research as it applies to gambling.</p>	
<p>Kate Speck, Ph.D., MAC, LADC</p>	<p>15D ~ Listening for Change...Looking for Motivation: Using Motivational Interviewing With Problem Gambling Clients</p> <p>Motivational interviewing is a directive, client-centered counseling style for eliciting behavior change by helping clients to explore and resolve ambivalence. This session will acquaint participants with basic concepts and methods and participants will engage in skill-building exercises. Dr. Kate Speck received training from MI founder Dr. Bill Miller and she is a member of the international Motivational Interviewing Trainer of Trainers (MINT).</p>	<p>Andy Kirk; 3rd Floor Marriott Tower **will be videotaped</p>
<p>Max H. Michelle J. Arnie W. Rick B.</p>	<p>15E ~ Panel Discussion ~ God, Gambling, Law, and Treatment: Unique Perspectives from Recovery</p> <p>Too often, people in the field, family members, and others, have a stereotype of people in recovery, and may lose sight of the fact that recovery is highly individual and dynamic. Each of these panelists will share their unique perspective to provide the audience with different points of view on these issues. The panel includes an agnostic, an attorney, a consultant to the gaming industry and a treatment provider.</p>	<p>Count Basie A1; 2nd Floor Marriott Tower</p>
<p>Jenny Brown Ron Griffith Mike Stone Moderator: Shelly Perez</p>	<p>15F ~ Effective Public Relations on a Shoestring Budget</p> <p>This panel discussion will present a variety of ideas to provide effective public relations and marketing strategies on a minimal budget. With some imagination and a little initiative, anyone can implement an effective public relations effort.</p>	<p>Count Basie B1; 2nd Floor Marriott Tower</p>
<p>10:00 – 10:30 a.m.</p>	<p>Networking Break & Poster Session ~ Snacks available in exhibit hall</p>	<p>Ballroom Foyer; 2nd Floor Marriott Tower</p>
<p>Katharine Papoff, B.H.Sc., ECE, M.Sc. Joan Norris, Ph.D.</p>	<p>16A ~ Itching for Scratch Cards: Instant Ticket Purchases and Problem Gambling Among Ontario Baby Boomers</p> <p>The objective of this poster is to encourage investigations of instant ticket purchase gambling (ITPG) as a risk factor for problem gambling, and to inform primary and secondary prevention strategies in the cohort of baby boomers. The goal of this research was to describe gambling experiences, attitudes, behaviors and consequences in the ITPG population of Ontarians born 1946-1964. Qualitative results from problem gambling counselors informed analysis of quantitative CPGI data from 2002 Canadian community Health Survey 1.2. Results confirmed that ITPG involvement is a risk factor for the development and maintenance of problem gambling. We conclude that problem gambling research designs should examine all aspects of person, process, context and time (PPCT) defined by Bronfenbrenner's biocological model.</p>	
<p>Kelsie Forbush, B.A., M.A. Martha Shaw, B.S.</p>	<p>16B ~ The Role of Neuropsychological Characteristics and Personality Traits in Pathological Gambling</p> <p>Research suggests that pathological gambling disorder (PG) is associated with fronto-temporal dysfunction. However, no prior study has examined whether neuropsychological characteristics add incremental variance to the prediction of PG over and above personality traits associated with PG. The purpose of this project was to conduct an intensive assessment of PG and controls. Results provide strong evidence of frontal dysfunction in those with PG ($p's < .001$). Individuals with PG had significantly elevated levels of impulsivity, novelty seeking, harm avoidance, and reward dependence as well as a greater number of depressive and dissociative symptoms compared to controls ($p's < .001$). Neuropsychological variables did not add significant incremental variance over personality traits in predicting PG. This study suggests a primary role for personality in predicting PG.</p>	
<p>Maya Chilese, M.A., PLMHP, CCGC</p>	<p>16C ~ Play It Safe! A Low Risk Gambling Public Awareness Campaign</p> <p>Play It Safe! If you choose to play, know the rules. This responsible gambling public awareness campaign was created to define responsible and low-risk</p>	

gambling, encourage social advocacy for responsible gambling, and educate about six low risk gambling tips. This campaign offers a prevention message, describes problem gambling, and identifies ways to “play it safe” for those who choose to gamble. This campaign targets three populations: public audiences, treatment, and prevention professionals. Examples of materials are available.

10:30 a.m. – noon

Concurrent Sessions

Larry Gasco, Ph.D.
Michael Liao, M.S.W.
Jonathan “Tana” Lepule, B.A.
Irma Martinez, M.A.
Peggy Thomas, B.A.

17A ~ Building Multicultural Coalitions: Lessons Learned from the Creation of the California Problem Gambling Prevention Coalition

In 2006, the national Asian Pacific American Families Against Substance Abuse (NAPAFASA) set out to create a statewide problem gambling prevention coalition that would address the heterogeneous needs of California, such as geographic diversity, ethnic diversity and attention to special populations such as older adults and members of the faith community. This panel will explain the creation and coordinated the NAPAFASA Problem Gambling Prevention Consortium. This project can serve as a model to agencies in other states who wish to implement similar programs.

Mary Lou Williams; 3rd Floor, Marriott Tower

Robert Boswell

17B ~ What Science Can Do For You: The Impact of NCRG on Understanding Gambling Disorders

Our understanding of gambling disorders has expanded dramatically within the past decade, with a third of all scientific research on this topic published between 1999 and 2003. The National Center for Responsible Gaming (NCRG), a nonprofit organization founded in 1996, has played a major role in this expansion of knowledge through its support of research investigations of gambling disorders at distinguished research centers including Harvard Medical School, Yale University Medical School, Johns Hopkins University, the University of California at Davis, and the University of Minnesota. The NCRG is now focused on how to apply this knowledge to strengthen responsible gaming programs sponsored by the gaming industry and gaming regulations aimed at reducing gambling-related harms. This session will examine how NCRG-funded research has advanced understanding of (1) the health risks of casino employees, including alcohol, smoking and gambling problems; (2) self-exclusion programs; and, (3) education of gaming employees.

Bennie Moten; 3rd Floor Marriott Tower

Jim Wuelfing, B.S., CPP-R, NRRP
Marlene D. Warner, M.A.
Rev. Gregory Hogan, Sr., M.Min., B.S.
Karen Hogan, RN, N.D., B.S.

17C ~ Building the Capacity of Colleges and Universities to Address Problem Gambling

This session will describe the college outreach initiative in Massachusetts. The components of the initiative (outreach and invitation, overview training, training on policy development, application for technical assistance and delivery of technical assistance, follow-up and evaluation) will be fully elaborated. Lessons learned will include successes and limitations. Program changes for year two of the project will be presented. Ample time will be given for questions, answers and discussion.

Julia Lea; 3rd Floor Marriott Tower
**will be videotaped

Robin Cato, J.D.
Keith Whyte
Jon Grant, M.D., J.D., M.P.H.

17D ~ The Two Addictions of the New Millennium: The Impact of Technology on Problem Gambling & Sexual Compulsivity

Sex and gambling continue to be transformed by computers and through the Internet. Problem gambling and sexual addiction are growing concerns. The presentation will review the similarities and differences between these behavioral addictions, discuss common issues, and share strategies to address current and future challenges.

Andy Kirk; 3rd Floor Marriott Tower
**will be videotaped

Jerry Bauerkemper
Tim Christensen, M.P.A.
Elizabeth B. (Lisa) Pertzoff, NCAC, NCGC
Mike Stone
Moderator:
Reece Middleton, M.A., LAC, CCGC

17E ~ Panel Discussion ~ Lobbying and Advocacy: What Is It? Can Councils and Counselors Do It?

What is lobbying, what is advocacy and can non-profits and individuals do it? Differences abound and perspectives change depending on the situation and state, but an effective program of raising awareness and obtaining services for those in need MUST include contact with legislators and government officials. Results of a recent survey on legislative priorities will be discussed. Panelists will also share information on successful campaigns and provide important suggestions on what NOT to do. Attendees will receive handouts with advocacy guidelines.

Count Basie A1; 2nd Floor Marriott Tower

Keynote Addresses and Featured Presenters

Addiction and Problem Gambling: The State of the State's Involvement

Friday, June 8 ~ 8:45 – 10:00 a.m.

Anne M. Herron, M.S., CRC, CASAC, NCACII

Anne M. Herron is the Director of the Division of State and Community Assistance at the Substance Abuse and Mental Health Services Administration's Center for Substance Abuse Treatment, (CSAT). The activities of the Division provide the primary link between CSAT and the States and Territories in the development and maintenance of treatment systems for persons with addictive disorders. The Division manages the Substance Abuse Prevention and Treatment Block Grant to the States and Territories, as well as activities that focus on Co-Occurring Disorders and Homelessness and the data needs of the Center for Substance Abuse Treatment and the States. The Division partners with States and Territories to improve treatment accountability, capacity, and effectiveness through infrastructure development, technical assistance, and administration of the \$1.76 billion Substance Abuse Prevention and Treatment Block Grant program, which in FY 06 accounted for 51 percent of SAMHSA's budget. In her leadership capacity, she is responsible for the supervision of 38 employees and the oversight of all Division activities.

Before coming to federal service, Ms. Herron worked in the New York State Office of Alcoholism and Substance Abuse Services where she served as Director of Treatment. In that capacity, she was responsible for the development and improvement of over 1,400 treatment programs throughout the state. In addition, Ms. Herron was directly accountable for the management of 13 state-operated inpatient addiction treatment programs whose 600 staff served more than 10,000 persons per year. Ms. Herron also served as the Special Program Assistant to the Commissioner with responsibilities for special projects as well as the Assistant Director of the Women, Children, and Families Bureau. Before her employment with the State Office of Alcoholism and Substance Abuse Services, Ms. Herron was a clinical director at the Alcoholism Council of Schenectady County, New York and has also provided direct clinical services in both community outpatient and residential programs.

Ms. Herron is a nationally certified addiction counselor, with more than 25 years of experience in the addiction treatment field. In addition, she is a certified rehabilitation counselor, as well as a family and adolescent therapist.

Ms. Herron received her M.S. degree in Rehabilitation Counseling from the State University of New York and her undergraduate degree from Loyola University of Chicago with a major in Psychology and advanced coursework in Philosophy, English and Political Science.

Future Issues in Gambling and Problem Gambling

Friday, June 8 ~ 12:30 - 1:30 p.m.



Keith Whyte

Keith S. Whyte became the Executive Director of the National Council on Problem Gambling (NCPG) in October 1998. The NCPG is the national advocate for programs and services to assist problem gamblers and their families.

Previously, Mr. Whyte served as Director of Research for the American Gaming Association where he was responsible for research and public policy issues, including problem gambling.

Prior experience includes the American Bar Association's Section of Individual Rights and Responsibilities where he dealt with policy issues relating to civil rights, human rights, healthcare, and immigration law. He worked in the office of the Assistant Secretary for Planning and Evaluation at the United States Department of Health and Human Services on healthcare policy issues. Keith graduated from Hampden-Sydney College with a B.A. in History and a Certificate in International Relations. He also studied at Leiden University, the Netherlands.

Mr. Whyte has written numerous articles, studies and book chapters on various aspects of gaming policy and presents frequently at national and international conferences. In addition, he has testified before the United States Congress on gambling-related legislation. He regularly discusses gaming issues in national and international print, radio and broadcast media. He is a member of the Editorial Board of the *Gaming Law Review* and the Editorial Advisory Board of the *Responsible Gaming Quarterly*. Keith also serves as a reviewer for the *Journal of Gambling Issues* and the Alberta Gaming Research Institute, and sits on the Advisory Boards of the International Centre for Youth Gambling Problems and High-Risk Behaviors at McGill University, the Center for Gambling Studies at Rutgers University and the Even Centre in Hong Kong.

Additional Presentations:

- ☞ *Concurrent Session/Panel Discussion 10F ~ Casino Gambling Comes to Kansas: Politics, Profits, and Problem Gambling ~ Saturday, 10:30 a.m. – 12:00 p.m.*
 - ☞ *Concurrent Session 17D ~ The Two Addictions of the New Millennium: The Impact of Technology on Problem Gambling & Sexual Compulsivity ~ Sunday, 10:30 – 12:00 p.m.*
-
-

Methamphetamine and the Brain, Implications for Behavior and Thought

Friday, June 8 ~ 3:30 - 5:00 p.m.



Thomas E. Freese, Ph.D.

Dr. Freese has worked in the substance abuse field since 1983 and is currently the Director of the Pacific Southwest Addictions Technology Transfer Center (PSATTC) and the Director of Training for UCLA Integrated Substance Abuse Programs (ISAP). He has been a featured presenter at conferences nationally and internationally on the impact and treatment of methamphetamine and opioid dependence.

He has been the Project Director on a number of studies including research on methamphetamine use and HIV risk. Dr. Freese has provided clinical training and workshops for clinicians-in-training at the all levels.

Additional Presentation:

- ☞ *Concurrent Session 3D ~ Buprenorphine: A New Approach to Opioid Treatment ~ Friday, 10:30 a.m. – 12:00 p.m.*

Problem Gambling and Substance Abuse Best Practices: Pharmacology and Cravings

Saturday, June 9 ~ 8:45 - 10:00 a.m.

Jon Grant, M.D., J.D., M.P.H

Jon Grant is an Associate Professor of Psychiatry at the University of Minnesota and co-directs a clinic for Impulse Control Disorders at the University of Minnesota Medical Center in Minneapolis, Minnesota.

Dr. Grant completed a law degree from Cornell University, a medical degree from Brown University, and a master's degree in public health from Harvard University. He is the author of *Stop Me Because I Can't Stop Myself*, a book on impulse control disorders, and editor of *Pathological Gambling: A Clinical Guide to Treatment and Textbook of Men's Mental Health*.

Dr. Grant is the editor in chief of the *Journal of Gambling Studies*. His research is funded by the National Institute of Mental Health.



Additional Presentation:

- ☞ *Concurrent Session 17D ~ The Two Addictions of the New Millennium: The Impact of Technology on Problem Gambling & Sexual Compulsivity ~ Sunday, 10:30 a.m. – 12:00 p.m.*
-
-

Developmental Perspective on Youth, Gambling, and Substance Abuse

Saturday, June 9 ~ 3:30 - 5:00 p.m.



Ken Winters, Ph.D.

Dr. Winters is the director of the Center for Adolescent Substance Abuse Research, a professor in the Department of Psychiatry at the University of Minnesota, Minneapolis, and a senior scientist with Treatment Research Institute, Philadelphia, PA . He received his B.A. from the University of Minnesota and a Ph.D. in Psychology (Clinical) from the State University of New York at Stony Brook.

His research interests include problem gambling and adolescent drug abuse. Dr. Winters has published numerous research articles and book chapters in these areas, and has received several research grants from the National Institute of Health and various foundations and state agencies. He is an associate editor for the *Psychology of Addictive Behaviors*, and is on the Editorial Board of the *Journal of Gambling Studies* and the *Journal of Substance Abuse Treatment*.

Dr. Winters served in 1999 as a member of the National Research Council's Committee on the Social and Economic Impact of Pathological Gambling, has been a member since 1990 of the Problem Gambling Research Committee for the State of Minnesota Department of Human Services, currently serves on the Scientific Advisory Panel for the Harvard Institute for Research on Pathological Gambling and Related Disorders, and he was the co-recipient of 2002 National Council on Problem Gambling Research Award. He recently received the 2005 National Center for Responsible Gaming Scientific Achievement Award.

His current research projects pertaining to problem gambling include the study of the course of young adult gambling and the development of a clinical battery for the identification, referral and treatment of individuals who may have a gambling problem.

Presenter Biographies

Eric N. Alexander, Ph.D., was born and raised in Jackson, WY; which explains his love of mountains and fly-fishing waters. He attended the University of Washington in Seattle as an undergraduate in psychology; the University of Wyoming as a Master's student in psychology; and is currently working towards a Doctorate in Education from the University of Wyoming. Eric is the Substance Abuse Prevention Coordinator for Oregon State University, where he has been working since June of 2005. Prior to his arrival at OSU, Eric worked for over six years at the University of Wyoming as the Assistant Director of the University Counseling Center with the primary role of addictive behaviors prevention coordinator. He has been working in the field of addictive behaviors prevention now for nearly a decade, has presented at numerous state and national conferences and has published in the area of substance abuse prevention/education. He currently lives in Albany, with his wife and new baby daughter.

☞ *Concurrent Session 5F-2 ~ Gambling on Campus: Addressing Risks and Realities ~ Friday, 1:30 – 3:00 p.m.*

Jerry Bauerkemper is the Executive Director of the Nebraska Council on Compulsive Gambling. Mr. Bauerkemper was the first director of problem gambling for the state of Nebraska. In addition he was appointed to the Nebraska's Commission on problem gambling. He is on the executive committee of the Board of Directors of the National Council on Problem Gambling. Mr. Bauerkemper has been providing counseling to gambling families since 1986. He has published research on the prevalence of problem gambling in the Nebraska Probation Department. He received the "First Step" award in 1999 for his work with problem gamblers. Mr. Bauerkemper is a nationally recognized expert on problem gambling and has provided training throughout the United States.

☞ *Concurrent Session/Panel Discussion 17E ~ Lobbying and Advocacy: What Is It? Can Councils and Counselors Do It? ~ Sunday, 10:30 a.m. – 12:00 p.m.*

Robert Boswell has served as the senior vice president of Pioneer Behavioral Health since February 1999. From 1992 to 1999, Robert served as executive vice president of Pioneer. Prior to that, he also served as administrator of the company's Highland Ridge Hospital Facility and is principally involved with its substance abuse and psychiatric facilities. From 1981 until 1989, he served as the associate administrator at the Prevention Education Outpatient Treatment Program - the Cottage Program, International. Robert was the President of Salt Lake County Alcohol and Drug providers program and the founder of Families in Focus - a science based prevention program for at risk youth. He worked with Dr. Fredrick Herzberg, the father of motivation hygiene theory for five years at the University of Utah in the Graduate School of Business. Robert serves on the Board of Directors for the National Center for Responsible Gaming and is a board member of the National Foundation for Responsible Gaming.

☞ *Concurrent Session 17B ~ What Science Can Do For You: The Impact of NCRG on Understanding Gambling Disorders ~ Sunday, 10:30 a.m. – 12:00 p.m.*

Claude Boutin, M.P.S., works for Laval University since 1997 in collaboration with Bob Ladouceur. He co-wrote two books with Bob: "Understanding and Treating the Pathological Gambler" just to name one. Claude has published scientific articles about excessive gambling in books, encyclopedia, and specialized magazines. Most of his works relate to responsible gambling strategies.

☞ *Concurrent Session 15A-1 ~ Improved Responsible Gaming Strategies: Self-Exclusion and Onsite Casino Centre ~ Sunday, 8:30 – 10:00 a.m.*

Jenny Brown is the Special Events & Public Relations Manager for Wayside Waifs Humane Society. Within the organization of 50+ employees, she helps to coordinate all media relations, including regularly scheduled adoption spots, press releases, on-site interviews, and general animal welfare questions. Previous to Wayside Waifs, Jenny worked as press secretary to Governor Bob Holden, coordinating all press conferences and media tours

☞ *Concurrent Session/Panel Discussion 15F ~ Effective Public Relations on a Shoestring Budget ~ Sunday, 8:30 – 10:00 a.m.*

Paula Burns, M.A., is currently the Ed/Prevention Administrator with the Arizona Office of Problem Gambling, a state agency. From June 2002 to April 2005, she administered the state-funded gambling treatment program. From 1997-2001 she was the Deputy Director of the Arizona Council on Compulsive Gambling where she concentrated on help line and outreach activities specializing in women's issues, older

adults and problem gambling education on tribal lands. She has given presentations throughout the country on these and other issues related to gambling. Prior to that, she had a career as a secondary public school teacher.

- ☞ *Concurrent Session 3B ~ Substance Abuse and Gambling Among Arizona Youth: Results of the Risk and Protective Survey 2006 ~ Friday, 10:30 a.m. – 12:00 p.m.*

David Carter, Ph.D., is a faculty member in the Graduate Counselor Education Program at the University of Nebraska at Omaha. Dr. Carter is Past President of the Nebraska Counseling Association and Nebraska Substance Abuse Directors Association. Dr. Carter has worked with clients suffering from addiction and compulsive issues for twenty-five years in private practice.

- ☞ *Poster Session 9A ~ AA + GA + TA = Relapse Prevention & Empowerment Model ~ Saturday, 10:00 – 10:30 a.m.*

Robin Cato, J.D., is the executive director for The Society for the Advancement of Sexual Health in Atlanta, Georgia. She is also an attorney at law in the state of Georgia. Robin teaches as an adjunct professor at John Marshall Law School in Atlanta.

Prior to her law career, she taught high school English in the Orlando, Florida, area. She earned her B.A. in English from Stetson University in Deland, Florida, and her law degree from Mississippi College School of Law, Jackson, Mississippi.

- ☞ *Concurrent Session 17D ~ The Two Addictions of the New Millennium: The Impact of Technology on Problem Gambling & Sexual Compulsivity ~ Sunday, 10:30 – 12:00 p.m.*

Maya Chilese, M.A., PLMHP, CCGC, is a mental health and gambling counselor and has designed Nebraska's first gender-specific program for female gamblers. She currently works in a clinical setting and in community coalitions. Ms. Chilese created the materials for Nebraska's first public awareness campaign for responsible gambling and is partnering to write and pilot a youth prevention curriculum.

- ☞ *Poster Session 16C ~ Play It Safe! A Low-Risk Gambling Public Awareness Campaign ~ Sunday, 10:00 – 10:30 a.m.*

Tim Christensen, M.P.A., is currently the Treatment Administrator for the Arizona Office of Problem Gambling. He is the current President of the Association of Problem Gambling Service Administrators, and serves on the Executive Committee of the Board of Directors for the National Council on Problem Gambling. He has extensive experience providing technical assistance and contract monitoring for public mental health and substance abuse services. Tim has provided consultation to numerous state governments on the development and implementation of publicly funded problem gambling programs.

Tim earned his Master of Public Administration degree from the University of Nebraska – Omaha in which his primary focus of research dealt with problem gambling programs and public policy.

- ☞ *Concurrent Session/Panel Discussion 10F ~ Casino Gambling Comes to Kansas: Politics, Profits, and Problem Gambling ~ Saturday, 10:30 a.m. – 12:00 p.m.*
- ☞ *Concurrent Session/Panel Discussion 17E ~ Lobbying and Advocacy: What Is It? Can Councils and Counselors Do It? ~ Sunday, 10:30 a.m. – 12:00 p.m.*

Marla A. Corwin, M.S.W., LCSW, CAC-III, is a Licensed Clinical Social Worker and a Certified Addictions Counselor. She is an instructor at the University of Colorado's School of Medicine, where she serves as Education Coordinator for the Mountain Plains AIDS Education and Training Center (MPAETC). Marla designs training materials and workshops on Substance Abuse, HIV Risk Assessment, Risk Reduction and Prevention, Sexual History Taking, HIV Risk and Prevention in Native American Communities, and Grief and Loss. Prior to working for the MPAETC, Marla worked for 10 years in a treatment facility for HIV-infected substance-dependent clients.

- ☞ *Concurrent Session 12F ~ Methamphetamine, Alcohol, and HIV: Risks and Prevention in Native American Communities ~ Saturday, 1:30 – 3:00 p.m.*

Renee Cunningham-Williams, Ph.D., M.P.E., LCSW, is one of the few social workers in the nation conducting award-winning epidemiologic & treatment research in pathological gambling and related disorders. Her research over the past decade is informed by her social work psychiatric epidemiology, and biostatistics training. She is a consultant to the NIH & SAMHSA, among others.

- ☞ *Poster Session 2A ~ Problem Gambling: Preliminary Results from KC-MO-GAM Household Study of Youth ~ Friday, 10:00 – 10:30 a.m.*

Bill Davies, Ph.D., is the Vice President of Corporate Affairs for the Saskatchewan Gaming Corporation (SGC), which operates Casinos Regina and Moose Jaw. He is responsible for the corporation's responsible gaming policies, including the development of the revolutionary iCare responsible gaming program. During his time at SGC he has worked to strengthen the corporation's reputation as a leader in the Canadian gaming industry and has several speaking opportunities at the Canadian Conference on Responsible Gaming, Canadian Gaming Summit and Exhibition, and International Gambling Centre in Auckland, New Zealand. Dr. Davies is SGC's liaison with the Department of Health, is treasurer of the Saskatchewan Responsible Gaming Association, a member of the Board of Directors for the Canadian Mental Health Association Regina Chapter, and participates on the Moose Jaw and Regina Problem Gambling Committees.

☞ *Concurrent Session 15A-2 ~ iCare: Integrating Responsible Gaming into Casino Operation ~ Sunday, 8:30 – 10:00 a.m.*

R. Kent Dean, Ph.D., has been a counselor in substance related disorders and existing psychiatric disorders for thirty years. His current emphasis is on treating those with pathological gambling in an intensive patient program setting through the Louisiana Association on Compulsive Gambling in Shreveport, and on providing continuing professional education.

☞ *Concurrent Session 10E ~ Practicum in Teaching Relapse Prevention Skills for Patients ~ Saturday, 10:30 a.m. – 12:00 p.m.*

Jeffrey Derevensky, Ph.D., is a child psychologist, and Professor of School/Applied Child Psychology, Department of Educational and Counseling Psychology; and Professor, Department of Psychiatry at McGill University. He is a clinical consultant to numerous hospitals, school boards, government agencies, and corporations. Dr. Derevensky has published widely in the field of youth gambling and is on the editorial board of several journals. Dr. Derevensky is co-director of the McGill University's Youth Gambling Research & Treatment Clinic and the International Centre for Youth Gambling Problems and High-Risk Behaviors..

☞ *Concurrent Session 10C ~ Preventing Youth Gambling Problems: An Examination of Some New Initiatives ~ Saturday, 10:30 a.m. – 12:00 p.m.*

Kate Diskin, Ph.D., is a clinical psychologist at the Addiction Centre, Calgary Health Region. She completed her doctorate in Clinical Psychology at the University of Calgary in 2006, where she conducted research in the process of change in problem gambling. Dr. Diskin received the New Investigator Award for this work from the International Conference on the Treatment of Addictive Behaviors. Dr. Diskin has also examined the role of attention and physiological factors in video lottery gambling, and received the NCPG Master's thesis award for her research on physiological factors in video lottery gambling.

☞ *Concurrent Session 12B ~ Effects of a Single Session Motivational Intervention on Problem Gambling Behavior ~ Saturday, 1:30 – 3:00 p.m.*

Gloria Donnelly, B.S., has a long history in the gaming industry and is currently Director of Sales at the Connecticut Lottery Corporation (CLC), where she was instrumental in the transition of the lottery from a state operation to a quasi-public corporation in 1996. Gloria's dedication to the integrity of the lottery combined with a balanced approach to marketing lottery products has resulted in steady growth in sales, which translates to greater contributions to the state's general fund. Gloria's academic background in public and community health has been instrumental in the development of CLC's strong commitment to raising awareness about problem gambling. She has worked closely with numerous local, regional and nationally recognized professionals, greatly enhancing CLC's efforts in this arena.

☞ *Concurrent Session 12C ~ The Soft Approach to Problem Gambling Prevention ~ Saturday, 1:30 – 3:00 p.m.*

Alberto Duarte, M.P.A., VP of Education at InCharge Education Foundation, is a recognized expert in personal finance education and instruction design and has developed many successful educational program for underserved populations. Al also serves as a board or committee member for American Savings Education Council, Jump\$tart Coalition, and CFA.

☞ *Concurrent Session 5A-2 ~ Financial Distress and Problem Gambling Go Hand in Hand ~ Friday, 1:30 – 3:00 p.m.*

Brian H. Farr, M.A., LPC, NCGC-II, has a private practice in Portland, Oregon. He has extensive clinical experience with individuals and families facing the complex issues of problem gambling. He also

has experience with drug and alcohol addiction, anxiety, depression and grief. Brian's interactions with workshop participants are enriched by his successful career in business. During the 25 years prior to becoming a counselor, he was a founding partner of an investment management firm, owner manager of a personnel agency, professional commodity trader and member of the Chicago Board of Trade.

- ☞ *Concurrent Session 5A-1 ~ Money: Therapeutic Strategies for Gambling Treatment ~ Friday, 1:30 – 3:00 p.m.*

Don Feeney, M.S., M.P.P., Research and Planning Director of the Minnesota Lottery since 1991, Don has over 25 years experience working with government agencies on a variety of issues. He serves on the boards of the National Council on Problem Gambling and the Northstar Problem Gambling Alliance. He holds a Master of Public Policy degree from the John F. Kennedy School of Government at Harvard, a Master of Science in statistics from the University of Minnesota, and a Bachelor of Science degree in applied mathematics from Brown University.

- ☞ *Concurrent Session 3F ~ Graphic Revelations: Effective Communications Through Statistical Graphics ~ Friday, 10:30 a.m. – 12:00 p.m.*
- ☞ *Concurrent Session 5D ~ Best Practices for Lottery Problem Gambling Programs ~ Friday, 1:30 – 3:00 p.m.*

Tim Fong, M.D., is the co-director of the UCLA Gambling Studies Program, a translational research and treatment program in Los Angeles. He completed medical school at Northwestern and his residency and addiction fellowship were at UCLA. He is now an assistant Clinical Professor of Psychiatry at the Semel Institute for Neuroscience and Human Behavior at UCLA.

- ☞ *Concurrent Session 5C ~ Is Problem Gambling Neurotoxic? ~ Friday, 1:30 – 3:00 p.m.*

Kelsie Forbush, M.A., is a graduate student in the Clinical Psychology Ph.D. program at the University of Iowa. She is a recipient of the Dean's Graduate Fellow (formerly the Graduate Merit Fellowship) and received honorable mention in the 2005-2006 Ford Foundation Pre-doctoral Fellowship. Ms. Forbush's research focuses on the intersection between personality and psychopathology with a particular emphasis on eating disorders and pathological gambling disorder.

- ☞ *Poster Session 16B ~ The Role of Neuropsychological Characteristics and Personality Traits in Pathological Gambling ~ Sunday, 10:00 – 10:30 a.m.*

Pat Fowler, Executive Director, Florida Council on Compulsive Gambling, Inc. (FCCG), is a national trainer and educator in the field of problem and compulsive gambling with 20 years experience. FCCG has served as the designated authority under contract with the state government for more than a decade while overseeing Florida's Problem Gambling Help Line.

- ☞ *Concurrent Session 5A-2 ~ Financial Distress and Problem Gambling Go Hand in Hand ~ Friday, 1:30 – 3:00 p.m.*

Joanna Franklin, M.S., NCGC-II, is currently the Director of Training and Network Development for Trimeridian Inc.- Resources for Problem Gambling that provides gambling-specific treatment protocols, clinical training, and supervision towards national certification in gambling counseling. Ms. Franklin is currently: Co-chair of the National Gambling Counselor Certification Board; President of the Institute for Problem Gambling; President of the Maryland Council on Problem Gambling and on the Board of Directors of the National Council on Problem Gambling. She is the winner of the National Council on Problem Gambling Goldman Award for a lifetime of dedicated services.

- ☞ *Concurrent Session 12A ~ Gender Differences in Adolescent Gambling in Inner-City Youth ~ Saturday, 1:30 – 3:00 p.m.*

Gina Fricke, M.S.W., LCSW, CCGC, NCGC-II, graduated from the University of Nebraska at Omaha with a Bachelor and Master degree in Social Work. Fricke has various experiences in human service fields including working as a police dispatcher, working in a residential treatment facility for adolescent girls, parenting education instructor and coordinator, and as a therapist. She currently works with gamblers and their family members in individual and group sessions, and frequently presents on gambling addiction to a variety of audiences, including therapists, community organizations, colleges, seniors, churches, and public representatives.

- ☞ *Poster Session 13C ~ Harm Reduction in Gambling Treatment or Addressing Precontemplation in Addicted Gamblers ~ Saturday, 3:00 – 3:30 p.m.*

Larry Gasco, Ph.D., is the Project Director of the National Asian Pacific American Families Against Substance Abuse (NAPAFASA) Problem Gambling Prevention Technical Assistance and Training project and is a member of the Los Angeles County Mental Health Commission. Prior to this, he served as the Director of the Roybal Family Mental Health Center in East Los Angeles and the Los Angeles County American Indian Counseling Center (AICC). He is an enrolled member of the Coastal Band of the Chumash Nation. In addition to extensive experience in administering mental health programs, Dr. Gasco worked for ten years with the Los Angeles County Drug Abuse Office.

☞ *Concurrent Session 17A ~ Building Multicultural Coalitions: Lessons Learned from the Creation of the California Problem Gambling Prevention Coalition ~ Sunday, 10:30 a.m. – 12:00 p.m.*

Gary Gonder, M.P.A., has served as the Missouri Lottery's Communications director since 1992. He oversees the Lottery's communication programs including media relations, publications, Web site, special events, the daily drawings, customer service, winner and beneficiary awareness, responsible gaming and the Lottery's Amber Alert program.

Mr. Gonder is past chairman and current vice chairman of the Missouri Alliance to Curb Problem Gambling. Gonder is a graduate of the Lottery Futures College and the Erewon State Lottery Case Studies Program. Gonder is a recipient of the National Association of State and Provincial Lotteries Powers Award and the Missouri Governor's Award for Quality and Productivity.

☞ *Concurrent Session 5D ~: Best Practices for Lottery Problem Gambling Programs ~ Friday, 1:30 – 3:00 p.m.*

Benton Granville, M.A., has more than 25 years experience working in senior level clinical and administrative positions in the mental health and addictions fields. He holds a Master of Arts degree from Northern Illinois University and is currently the Director of New Business Development for Keystone Treatment in Sioux Falls South Dakota.

☞ *Concurrent Session 5B ~ Addictions and Family Violence: A Collaborative Approach ~ Friday, 1:30 – 3:00 p.m.*

Ron Griffin, B.A., M.S.W., M.S.A., is Vice President of the National Council on Alcoholism and Drug Dependence of Greater Kansas City (NCADD-KC). Ron has an extensive history working with a variety of mental health and substance abuse fields. He has worked in drug treatment for over 10 years as well as working in drug prevention for 14. His clinical experience includes adults, youth, substance abuse, mental health, eating disorders and hospice. In community mobilization Ron has worked with a variety of advocacy issues in public initiatives at the local, state and national level.

☞ *Concurrent Session/Panel Discussion 15F ~ Effective Public Relations on a Shoestring Budget ~ Sunday, 8:30 – 10:00 a.m.*

Rina Gupta, Ph.D., is a practicing child psychologist and Assistant Professor (part-time) of School/Applied Child Psychology, Department of Educational and Counseling Psychology at McGill University. She has published widely and has focused her research and social policy work in the area of youth gambling issues.

Dr. Gupta is on the editorial board of the *Journal of Gambling Studies* and is co-director of the McGill University Youth Gambling Research & Treatment Clinic and the International Centre for Youth Gambling Problems and High-Risk Behaviors. Dr. Gupta has numerous publications in the field of youth gambling and has provided expert testimony before a number of provincial and federal commissions in Canada, United States, South Africa and Singapore. She is the recipient of the 2006 National Center for Responsible Gaming Young Investigator award.

☞ *Concurrent Session 10C ~ Preventing Youth Gambling Problems: An Examination of Some New Initiatives ~ Saturday, 10:30 a.m. – 12:00 p.m.*

Carolyn Hawley, Ph.D., is a Visiting Assistant Professor in the Rehabilitation Counseling Program at West Virginia University. Dr. Hawley currently serves as Secretary of the West Virginia Council on Problem Gambling.

☞ *Poster Session 2B ~ Characteristics of Employees with Self-Reported Gambling Problems Seeking Help ~ Friday, 10:00 – 10:30 a.m.*

Brian Herder has served as the agency principal and executive creative director since 1984. Brian Herder leads Russell Herder's innovative creative department and is ultimately responsible for strategic creative positioning of client brands across all service areas.

- ☞ *Concurrent Session 5F-1 ~ "Beat the Bet": Designing a College Gambling Campaign ~ Friday, 1:30 – 3:00 p.m.*

Dean Hestermann, M.A., has served in a variety of roles at Harrah's since 1992. In his current position, he provides guidance for the company on public policy and social responsibility issues. He is also a board member of the National Council on Problem Gambling.

- ☞ *Concurrent Session/Panel Discussion 10F ~ Casino Gambling Comes to Kansas: Politics, Profits, and Problem Gambling ~ Saturday, 10:30 a.m. – 12:00 p.m.*

Rev. Gregory Hogan, Sr., M.Min., B.S., and **Karen W. Hogan**, RN, N.D., B.S.; Rev. Hogan is Pastor of Barberton First Baptist Church in Barberton, Ohio. Rev. Hogan has a B.S. from Tennessee Temple University, a Master of Ministry from Evansville Seminary, and is a former City Councilman for the City of Seven Hills, Ohio. Dr. Karen Hogan is the Head Nurse Manager with University Hospitals/Case Medical Center in Cleveland, Ohio. She obtained her B.S. from Cedarville University, and her N.D. from Francis Payne Bolton School of Nursing, Case-Western Reserve University (CWRU) in Cleveland, Ohio. Dr. Hogan is a former faculty member of CWRU, Cuyahoga Community College, and Clinical Faculty at Kent State University.

Rev. Hogan and Dr. Hogan are married and they have four children. The Hogans' son, Greg Jr., was the president of the class of 2008 for the freshman and sophomore years, member of the university orchestra at Lehigh University, Bethlehem, PA. Shortly after arriving in college, Greg Jr. became addicted to Internet gambling, and in December of 2005 he committed a bank robbery to get more money to feed his addiction. He went through treatment at CORE in Shreveport, LA, and is currently serving a sentence of 22 months to 10 years in the Pennsylvania State Correctional system.

Rev. Hogan and Greg Jr. have appeared on Good Morning America, the E Channel, local television stations, and feature articles in the New York Times Magazine, USA Today, and other news outlets. Rev. Hogan has been in forums at universities, and with U.S. Congressmen.

- ☞ *Concurrent Session 17C ~ Building the Capacity of Colleges and Universities to Address Problem Gambling ~ Sunday, 10:30 a.m. – 12:00 p.m.*

Eric Hunsberger, M.S., is the Program Manager for Nebraska's Gamblers Assistance Program with the Division of Behavioral Health Services. In this position he oversees all contracts related to gambling treatment, prevention, helpline, media and research in the state of Nebraska. He also has extensive experience as a community health educator working with local governments, community based organizations, and public school systems.

- ☞ *Concurrent Session 12D ~ Community Mobilization: Multistate Collaboration of Problem Gambling Treatment, Training, and Prevention Strategies ~ Saturday, 1:30 – 3:00 p.m.*

Clark Kopelman received his B.A. in psychology from Grinnell College in 2004 and is currently completing his MSW at the Brown School at Washington University in St. Louis, where his research has focused on factors associated with mental health and substance abuse.

- ☞ *Poster Session 9C ~ The Application of Social Learning Theory to Gender Differences in Undergraduate Binge Drinking ~ Saturday, 10:00 – 10:30 a.m.*

Jonathan "Tana" Lepule, B.A., is a native of San Diego and has been an advocate of Asian and Pacific Islander health issues for over six years with the Union of Pan Asian Communities (UPAC). Mr. Lepule has conducted cultural competency workshops for San Diego County Health and Human Services Department and also gave presentation at the local, state, and national level. He is currently working with casinos to develop policies and expand existing smoke-free areas. He also served on the San Diego Mayor's (2003-2005) and Police Chief's (2002-present) Asian and Pacific Islander advisory board. Lepule graduated from San Diego State University where he also was a co-founder of the Pacific Islander Student Association. He has been a member of the Samoan Community Council and was the 2005 President of the Pacific Islander Festival Association.

- ☞ *Concurrent Session 17A ~ Building Multicultural Coalitions: Lessons Learned from the Creation of the California Problem Gambling Prevention Coalition ~ Sunday, 10:30 a.m. – 12:00 p.m.*

Michael Liao, M.S.W., has been involved in the past five years in providing training on issues such as domestic violence and cultural competence. Currently, Michael serves as the Project Manager on the Chinese Community Problem Gambling Project at NICOS Chinese Health Coalition. In this capacity, he has conducted statewide trainings for diverse groups on the issue of problem gambling. Michael is also the author / editor for the California Problem Gambling Prevention Technical Assistance and Training Project's Train the Trainers Curriculum. For his graduate project, Michael has also conducted primary research on the link between problem gambling and domestic violence.

☞ *Concurrent Session 17A ~ Building Multicultural Coalitions: Lessons Learned from the Creation of the California Problem Gambling Prevention Coalition ~ Sunday, 10:30 a.m. – 12:00 p.m.*

Gene Lutz, Ph.D., is Professor of Sociology and Director of the Center for Social & Behavioral Research at the University of Northern Iowa. He has directed research projects on many public health topics, including studies of problem gambling, substance abuse, tobacco use, behavioral health surveillance, and health disparities.

☞ *Concurrent Session 3A ~ Useful Problem Gambling Treatment Outcomes Monitoring ~ Friday, 10:30 a.m. – 12:00 p.m.*

Duane Mackey, Ed.D, is Prairielands ATTC South Dakota Coordinator and is Assistant Professor with the Alcohol and Drug Abuse Studies Department at the University of South Dakota. Prior to these appointments, Dr. Mackey worked for over thirteen years with the Indian Health Service, primarily providing counseling and related mental health services for Native American patients dually diagnosed with diabetes and alcohol abuse. He obtained his Ed.D. in Educational Psychology and Counseling from the University of South Dakota.

☞ *Concurrent Session 15B-2 ~ Native American Culture and Treatment Effects ~ Sunday, 8:30 – 10:00 a.m.*

Jeffrey J. Marotta, Ph.D., was trained as a clinical psychologist at the University of Nevada, Reno and has specialized in the field of problem gambling since 1997. He is a certified gambling addiction counselor, researcher, author, trainer, and consultant. Dr. Marotta currently serves as the Director of Oregon Problem Gambling Services, Clinical Faculty at Oregon Health Sciences University, and as Vice-President to the Association of Problem Gambling Service Administrators. He has trained and consulted nationally and internationally on topics of gambling and public health, including gambling treatment, gambling policy, problem gambling prevention, system development, and problem gambling awareness.

☞ *Concurrent Session 5F-2 ~ Gambling on Campus: Addressing Risks and Realities ~ Friday, 1:30 – 3:00 p.m.*

☞ *Concurrent Session/Panel Discussion 10F ~ Casino Gambling Comes to Kansas: Politics, Profits, and Problem Gambling ~ Saturday, 10:30 a.m. – 12:00 p.m.*

Irma Martinez, M.A., is an Associate with the Latino Behavioral Health Institute (LBHI), where she has worked since 2003. She coordinates the LBHI Annual Latino Conferences, which typically draw 1000+ participants from all over the country. Ms. Martinez has also worked for the Los Angeles County Department of Mental Health since 1991. She is currently a Mental Health Analyst with the DMH Emergency Outreach Bureau. Ms. Martinez is a native of Mexico where she studied at the University of Guadalajara, School of Psychology. She migrated to the United States in 1990. Ms. Martinez received a Master Degree in Psychology at California State University of Los Angeles in 1995.

☞ *Concurrent Session 17A ~ Building Multicultural Coalitions: Lessons Learned from the Creation of the California Problem Gambling Prevention Coalition ~ Sunday, 10:30 a.m. – 12:00 p.m.*

Silvia Martins, M.D., Ph.D., has a faculty appointment in the Department of Mental Health, Johns Hopkins Bloomberg School of Public Health. Dr. Martins was awarded in 2004 a young investigator incentive grant from the Institute for Research on Pathological Gambling and Related Disorders to investigate associations of gambling disorders with drug use, childhood deviant behaviors, and deviant peer relationship among African-American adolescents living in Baltimore, which enabled data collection of gambling measures in the JHU PIRC Second Generation Intervention Trial. Dr Martins also has several publications on clinical and epidemiological research of pathological gambling.

☞ *Concurrent Session 12A ~ Gender Differences in Adolescent Gambling in Inner-City Youth ~ Saturday, 1:30 – 3:00 p.m.*

Joan Masters, M.Ed., is the coordinator of Missouri Partners in Prevention, a statewide higher education consortium dedicated to reducing high risk and underage alcohol use. She directs several projects related to promoting positive health behavior among college students. Joan received her Master's degree in Counseling Psychology with emphasis in College Student Development from the University of Missouri-Columbia. She is currently the national chairperson of The Network Addressing College Alcohol and Other Drug Issues, a national organization whose focus is to decrease alcohol and drug abuse and violent behavior on college campuses across the United States.

- ☞ *Concurrent Session 10B ~Rolling the Dice: Gambling with College Life. Examining a State's College Problem Gambling and Substance Abuse Prevention Programs ~ Saturday, 10:30 a.m. – 12:00 p.m.*

Jessica McBride is a Master's student in School Applied Child Psychology and the International Centre for Youth Gambling Problems and High Risk Behaviors at McGill University. Her research centers on the gambling behavior of college and university students with a focus on internet gambling.

- ☞ *Poster Session 6B ~ Youth Gambling and the Internet: A Preliminary Examination ~ Friday, 3:00 – 3:30 p.m.*

Susan D. McLaughlin, M.P.A., CPP-R, Primary Prevention Services Coordinator for DMHAS Problem Gambling Services, oversees the state network of gambling prevention programs, collaborates with the state prevention infrastructure and community organizations, develops and delivers training and education programs, and consults on a variety of initiatives with these organizations. Prior to entering the problem gambling field in 1997, Susan worked with Connecticut youth and families in the fields of education, human services, and substance abuse prevention for twenty years. Her publications include contributions to college texts on working with at-risk youth, and papers on work and family stress management and disordered gambling. She is a nationally certified Prevention Practitioner.

- ☞ *Poster Session 2C ~ A Statewide Collaborative Approach to Planning and Implementing School Based Problem Gambling Prevention Programs ~ Friday, 10:00 – 10:30 a.m.*
- ☞ *Concurrent Session 12C ~ The Soft Approach to Problem Gambling Prevention ~ Saturday, 1:30 – 3:00 p.m.*

Dennis McNeilly, Psy.D., is a clinical geropsychologist and associate professor of psychiatry in the University of Nebraska Medical School's Department of Psychiatry in Omaha, where he also serves as the Associate Director of Medical Student education in psychiatry. Dr. McNeilly holds master's degrees in theology and psychology. He graduated with a doctorate in psychology from the Illinois School of Professional Psychology in Chicago and completed a postdoctoral research fellowship in geropsychology at the University of California Los Angeles. Dr. McNeilly received clinical training at the Loyola University of Chicago Medical Center Department of Psychiatry, the Northwestern University Psychiatric Institute, and the West Los Angeles Veteran's Affairs Medical Center in Brentwood.

Dr. McNeilly's clinical practice includes the psychotherapeutic treatment of depression, anxiety, impulse control disorders, and neuropsychological assessment of Alzheimer's and other dementias in older adults. His research interests include problem gambling in older adults, victimization of older adults, anxiety disorders in older adults, and the assessment and treatment of depression in older adults.

Dr. McNeilly is a nationally recognized speaker and researcher on problem gambling among older adults. He is the past Co-Chair of the Ethics Committee of the Nebraska Psychological Association and currently serves on the board of directors of the National Council on Problem Gambling and the Advisory Council of the Midlands Chapter of the Alzheimer's Association. He is a member of the American Psychological Association, the Nebraska Psychological Association, the Gerontological Society of America, the American Directors of Medical Student Education in Psychiatry, the National Council on Problem Gambling, and the Creighton University Jesuit Community.

- ☞ *Conference Welcome ~ Friday, 8:30 a.m.*

Reece Middleton, M.A., LAC, CCGC, serves as the Executive Director of Louisiana Association on Compulsive Gambling. He oversaw the development of CORE – Center of Recovery, a residential treatment center for pathological gamblers in Shreveport, Louisiana, as well as the Louisiana Problem Gamblers Helpline, which answers for numerous states. Reece has over twenty five years experience in the field of addictions treatment and management, including credentials as a program director, counselor, employee assistance specialist, referrals development and marketing director.

Middleton holds a Master of Arts degree in Counseling and professional board certifications in substance abuse (1983) and compulsive gambling counseling (1996). He has made many presentations on addictions to national and state conferences, businesses and colleges. Reece formerly served as a Commissioner on the Alcohol & Drug Abuse Commission, was appointed by the Governor of Louisiana and confirmed by the Louisiana State Senate. He is immediate Past Executive Vice President of the National Council on Problem Gambling, where he served on the Executive Committee. He was the recipient of the 1999 State of Louisiana Professional Award, given by the Office for Addictive Disorders and the 2006 Herman Goldman Award given by the National Council on Problem Gambling.

☞ *Concurrent Session/Panel Discussion 17E ~ Lobbying and Advocacy: What Is It? Can Councils and Counselors Do It? ~ Sunday, 10:30 a.m. – 12:00 p.m.*

Mia Moran-Cooper, B.S.W., LSW, has been Director of the Problem Gamblers Help Network of West Virginia since it began in 2000. In 2006 she was named Social Worker of the Year in West Virginia for her efforts to bring attention to the plight of problem gamblers and their loved ones. She has presented the innovative West Virginia model and its data at several national conferences, and at the International Think Tank on Problem Gambling in Auckland, New Zealand, and will be presenting at the Alberta Gaming Research Institute Annual Conference.

☞ *Poster Session 13B ~ Almost Heaven...The Story of the West Virginia Recovery Weekend ~ Saturday, 3:00 – 3:30 p.m.*

Michelle Neitch, B.S., is currently working as a Research Analyst in the Statistical Analysis Center of the Arizona Criminal Justice Commission. She is the lead researcher of the Arizona Youth Survey. This project surveyed 8th, 10th, and 12th graders across the state of Arizona on issues relating to substance use, risk and protective factors, delinquency, and other problem behaviors. Michelle is also currently working on receiving her MA in Criminal Justice, with a focus on juvenile delinquency. Prior to this position she worked as a research assistant for Arizona State University, where she worked on a wide array of criminal justice projects.

☞ *Concurrent Session 3B ~ Substance Abuse and Gambling Among Arizona Youth: Results of the Risk and Protective Survey 2006 ~ Friday, 10:30 a.m. – 12:00 p.m.*

Rena Nora, M.D., is a Board Certified Psychiatrist and Distinguished Fellow of the American Psychiatric Association. She is a Clinical Professor of Psychiatry at the University of Nevada School of Medicine. She serves as Medical Advisor of the Nevada Council on Problem Gambling. She is President of the National Certification Board for Gambling Counselors. She is a Commissioner of the Governor's Commission on Mental Health and Developmental Services and member of the Board of Examiners for Alcohol, Drug and Gambling Counselors. Dr. Nora served as Chief of Psychiatry Service in the VA Healthcare System (Lyons, New Jersey and Las Vegas, Nevada) for over twenty years with specialized qualifications and expertise in treating problem gamblers and their families. She has several lectures and publications on cultural psychiatry, suicide and PTSD. Dr. Nora is currently the Medical Director of the Intensive Outpatient Program for Problem Gamblers at the VA Southern Nevada Healthcare System. She is the recipient of the 2005 Herman Goldman Award given by the National Council on Problem Gambling as its highest award in recognition of a lifetime of personal commitment to problem gambling issues.

☞ *Concurrent Session 10D ~ Cultural Competency in Clinical Supervision ~ Saturday, 10:30 a.m. – 12:00 p.m.*

Joan Norris, Ph.D., is a Registered Psychologist with a Ph.D. in Social Psychology and Dean of the Faculty of Graduate Studies at Wilfrid Laurier University. She has extensive research experience and publications in the field of intergenerational relationships and gerontology. Ongoing projects include gambling amongst intergenerational and multi-ethnic families, funded by the Ontario Problem Gambling Research Center. Norris is the author or co-author of three books, 11 chapters in books, 26 refereed journal articles, five papers in refereed conference proceedings and nine technical reports, and have read more than 80 papers of abstracts at scientific meetings.

☞ *Poster Session 16A ~ Itching for Scratch Cards: Instant Ticket Purchases and Problem Gambling Among Ontario Baby Boomers ~ Sunday, 10:00 – 10:30 a.m.*

Katharine Papoff, B.H.Sc., ECE, M.Sc. Candidate in Social Gerontology (M.Sc. completion anticipated spring 2007) and is Coordinator for the Intergenerational and Multi-Ethnic Gambling Research Project at the University of Guelph. She is completing a Master of Science in Social Gerontology. Papoff is a baby boomer with long experience as a child development consultant to child care staff and to families.

This led to her current research interest in the importance of intergenerational influences and cohort effects, as well as the effects of legalized gambling on families in Ontario. Her ticket purchase gambling research is funded by the Ontario Problem Gambling Research Center.

- ☞ *Poster Session 16A ~ Itching for Scratch Cards: Instant Ticket Purchases and Problem Gambling Among Ontario Baby Boomers ~ Sunday, 10:00 – 10:30 a.m.*

Cynthia (Cindy) Payne, M.A., Director of Cultural Development - Isle of Capri Casinos, Inc. and started her gaming career in 1995 at Bullwhacker's Casino in Central City, Colorado. She joined Isle of Capri Casino in Black Hawk, Colorado in November 1998 as Training and Employment Manager, promoted to Corporate Employee Development Manager in 2000 and Director of Cultural Development in May 2002. Prior to working in the gaming industry Payne was Education Director for the American Institute of Banking in Denver, Colorado, a private, non-profit education/training organization, and worked 10-years in commercial banking, and four years as a public junior and senior high school teacher and athletic coach.

- ☞ *Concurrent Session 3E ~ The Gaming Industry's commitment to Responsible Gaming ~ Friday, 10:30 a.m. – 12:00 p.m.*

Shelly Perez is the Responsible Gaming Program coordinator for the Missouri Lottery. Perez oversees the Lottery's responsible gaming programs, trains Lottery employees on problem gambling sensitivity and coordinates many of the Missouri Alliance to Curb Problem Gambling activities. She was instrumental in the creation of the Alliance and serves as the media contact and resource for the Alliance. She facilitates its awareness programs including the in-school youth problem gambling awareness program, "Addiction – The Game No One Wins." She helped to write and produce an award-winning video and facilitator's guide on youth addictions, "Beat Addiction – Choose the Right Path." She conducts public education and outreach efforts on responsible gambling, problem gambling and underage gambling prevention. She also develops educational materials for these efforts. She has presented workshops on problem gambling prevention at national and international conferences. She is a member of the Missouri Lottery's speakers' bureau, active with media relations and is the publications coordinator for the Lottery.

- ☞ *Concurrent Session/Panel Discussion 15F ~ Effective Public Relations on a Shoestring Budget ~ Sunday, 8:30 – 10:00 a.m.*

Elizabeth B. "Lisa" Pertzoff, NCAC, NCGC, is the Executive Director of the Delaware Council on Gambling Problems. She has been active in the addictions field for more than 30 years, and with the Council since 1984. Ms. Pertzoff spends a significant amount of time advocating for the agency's mission: "To raise public awareness that compulsive gambling is a treatable disorder, and to facilitate development of a network of services for compulsive gamblers and their families in Delaware." Ms. Pertzoff is a member of the Governor's Advisory Council on Alcoholism, Drug Abuse and Mental Health and is on the Board of Directors of the National Council on Problem Gambling, Inc.

- ☞ *Concurrent Session/Panel Discussion 17E ~ Lobbying and Advocacy: What Is It? Can Councils and Counselors Do It? ~ Sunday, 10:30 a.m. – 12:00 p.m.*

Candace Peters, M.A., CADC, received her Master of Arts degree in Substance Abuse and Mental Health Counseling, at the University of Iowa and completed her Bachelor of Arts training at the University of Iowa majoring in Psychology and Sociology. She has served persons with substance abuse issues in an Iowa substance abuse treatment facility as clinical supervisor, and as residential, outpatient, and aftercare counselor with an emphasis on clients with co-occurring disorder.

Ms. Peters has supported counselors with clinical supervision at all levels of care. She developed, supervised, managed, and administered outreach and case management programs, and transitional housing programs for persons and their families in substance abuse recovery and who are homeless. She has served as a community, state, and national advocate for persons and their families who are in substance abuse recovery, are homeless, and have co-occurring disorder. Ms. Peters is the Director of Training with the Prairielands ATTC. She has delivered numerous presentations from a multi-disciplined approach in the areas of supervision, pharmacological treatment, counseling theory and practice, motivational techniques, and women and children's issues.

- ☞ *Conference Welcome ~ Friday, 8:30 a.m.*

- ☞ *Concurrent Session 5E ~ Clinical Supervision: An Art of the Past or the Future? ~ Friday, 1:30 – 3:00 p.m.*

Barbara Porto, B.A., as a veteran of the lottery industry since 1972, Barbara Porto has served the Connecticut Lottery Corporation since its inception more than 35 years ago. As part of her responsibility, Ms. Porto directs the Lottery's Responsible Gambling Program. She has worked with professionals in the fields of prevention and treatment and has spoken at national conferences, as well as state and local business organizations. She was recently instrumental in designing and carrying out employee training programs on this important topic. She is a member of the Partnership for Responsible Gambling and the Connecticut Women's Problem Gambling Project.

- ☞ *Concurrent Session 5D ~ Best Practices for Lottery Problem Gambling Programs* ~ Friday, 1:30 – 3:00 p.m.
- ☞ *Concurrent Session 12C ~ The Soft Approach to Problem Gambling Prevention* ~ Saturday, 1:30 – 3:00 p.m.

Jennifer Reynolds, M.Ed., has spent the past 4 years as a project manager, researcher, and consultant, specializing in gambling prevention, education and policy. Currently she is the Project Manager of the Public Health Gambling Project and Ph.D. student in the Department of Public Health Sciences, Faculty of Medicine at the University of Toronto, Canada. Jennifer received her Masters of Education, specializing in adolescent high risk behaviors and self-concept.

Jennifer currently works with Dr. David Korn on a number of gambling research projects at the University of Toronto: “*Prevention and Intervention of Youth Gambling Projects using the Internet*”; and “*Commercial Gambling Advertising: Understanding the Youth Connection*”.

- ☞ *Poster Session 9B ~ Youth Voices: Gambling Expression and Action Through Media Technologies* ~ Saturday, 10:00 – 10:30 a.m.

Norman Richardson, B.S., began his gaming career with the Nevada Gaming Control Board in 1984 where he audited Nevada licensed casinos and investigated applicants for gaming licenses. He became licensed as a Nevada CPA in 1989, and joined Primadonna Resort & Casino, in Primm, Nevada in 1993 as an Internal Auditor. In 1994 Richardson joined Boyd Gaming Corporation, as Compliance Manager. He joined Ameristar Casinos, Inc., in 1999. Richardson is currently V.P. of Compliance and Compliance Officer. He currently oversees the Compliance department for Ameristar at seven properties in five jurisdictions.

- ☞ *Concurrent Session 3E ~ The Gaming Industry's commitment to Responsible Gaming* ~ Friday, 10:30 a.m. – 12:00 p.m.

Brian Rockey, M.P.A., M.P.S., has been associated with the Nebraska Lottery since its start-up in 1993. Prior to joining the Lottery, he served as Special Assistant to the Tax Commissioner. In addition to having worked in the Nebraska Legislature, Rockey held senior staff positions in the offices of governors Bob Kerry and Ben Nelson. A 1983 graduate of Creighton University, Rockey holds graduate degrees in Political Science and Public Administration from the University of Nebraska--Lincoln and the University of Nebraska at Omaha, respectively.

- ☞ *Concurrent Session 5D ~ Best Practices for Lottery Problem Gambling Programs* ~ Friday, 1:30 – 3:00 p.m.

Jennifer Shatley, M.S., has been Code of Commitment Director for Harrah's, the largest U.S- casino operator, since 2001. Her duties include implementation and administration of the company's responsible gaming programs, as well as development of employee training and information technology to support the responsible gaming policy. She has been with Harrah's since 1997 and was previously the Senior Manager of Market Research. She earned a B.A. in English from Christian Brothers University, an M.S. in Communications from the University of Tennessee, and attended law school at Louisiana State University.

- ☞ *Concurrent Session 10A ~ Harrah's Responsible Gaming Training: Development and Evaluation* ~ Saturday, 10:30 a.m. – 12:00 p.m.

Martha Shaw, B.S., is the clinical trials coordinator for Dr. Donald W. Black, M.D., in the Department of Psychiatry at the University of Iowa. She is currently coordinating several research grants funded by the National Institute of Mental Health, pertaining to pathological gambling disorder. Ms. Shaw is also a co-author on two recently published papers concerning the treatment of pathological gambling disorder.

- ☞ *Poster Session 16B ~ The Role of Neuropsychological Characteristics and Personality Traits in Pathological Gambling* ~ Sunday, 10:00 – 10:30 a.m.

Anne Helene Skinstad, Ph.D., provides training for health professionals as the program director of the Prairielands Addiction Technology Transfer Center and as assistant professor of public health at the University of Iowa. A clinical psychologist, she also has conducted substance abuse research, with a special focus on women. She began teaching at the University of Iowa in 1990.

Prior to this appointment, Dr. Skinstad was the chief psychologist for an inpatient treatment unit for alcoholic women at the Hjeltestad-Clinic in Bergen, the first of its kind in Norway. She has provided administrative and clinical supervision to staff as well as students in psychology and substance abuse since 1977. Her research and clinical interests continue to be on assessment and treatment of women with substance use disorders and the treatment and assessment of clients with coexisting psychiatric disorders and substance dependence.

She was a member of the National ATTC Curriculum Committee that authored the nationally acclaimed *Addiction Counseling Competencies: the Knowledge, Skills and Attitudes of Professional Practice*.

- ☞ *Concurrent Session 5E ~ Clinical Supervision: An Art of the Past or the Future?* ~ Friday, 1:30 – 3:00 p.m.

Dan Smith, M.A., ABD, LCSW, CCGC, NCGC, is a well known trainer and clinical consultant for the National Council on Problem Gambling, and a member of the Missouri Council on Problem Gambling Concerns, Inc. He is also Clinical Director of Responsible and Problem Gambling Programs, Community Services of MO, Inc., an outpatient treatment facility for gamblers & their families in St. Louis MO.

- ☞ *Concurrent Session 12E ~ Dismantling the Stigma of Recovery: Grief as an Impactful Therapeutic Process* ~ Saturday, 1:30 – 3:00 p.m.

Kate Speck, Ph.D., MAC, LADC, has had over 28 years of working in the field of addiction, including a Master's in Addiction Counseling. Her Ph.D. is in Community & Human Resources, and she is currently assistant professor at Doane College-Lincoln, teaching both addictions and psychology courses. She is also Addictions Training director at Doane-Lincoln and serves as the Prairielands Addiction Technology Transfer Center (PATTC) coordinator for Nebraska.

Kate has worked in residential, outpatient and in EAP settings. Kate has developed and directed addictions programs in Iowa, Louisiana, and in Nebraska. In addition, she has managed addiction treatment services for pregnant women, education programs for addiction professionals, and has served schools in Nebraska managing prevention/intervention programs for 15 years. Kate's specialties include: working with families with addiction, she is a member of the Motivational Interviewing Network of Trainers, and has 18 years experience addressing adolescent substance abuse. She continues to work in the field of addictions through supervision of substance abuse professionals in clinical practice.

- ☞ *Concurrent Session 6C ~ Listening to Their Voices* ~ Friday, 3:00 – 3:30 p.m.
- ☞ *Concurrent Session 15D ~ Listening for Change...Looking for Motivation: Using Motivational Interviewing With Problem Gambling Clients* ~ Sunday, 8:30 – 10:00 a.m.

Timothy A. Steenbergh, Ph.D., is Associate Professor of Psychology and Director of the Lilly Student Research Initiative at Indiana Wesleyan University. His research has focused on problem gambling prevention, assessment and treatment. He also enjoys teaching and providing psychotherapy at a small clinical practice in Marion, IN.

- ☞ *Poster Session 13A ~ Labeling Practices of U.S. Lotteries* ~ Saturday, 3:00 – 3:30 p.m.

Pat Stilen, LCSW, CADAC, is the Director of the Mid-America Addiction Technology Transfer Center (MATTC) in residence at the University of Missouri-Kansas City. For over 20 years, she has worked in the mental health and substance abuse treatment fields as clinician, clinical supervisor, trainer, addictions educator, and administrator. Stilen has also worked in director roles in residential treatment programs for women and in statewide training programs for addiction counselors. As the Mid-America ATTC Director, she works closely with the Arkansas, Kansas, Missouri, and Oklahoma state agencies and provides technical assistance and oversight to regional system-change initiatives. She is the primary author of Mid-America ATTC curriculum products, *A Collaborative Response: Addressing the Needs of Consumers with Co-Occurring Substance Use and Mental Health Disorders*, used to initiate system-changes in Kansas and in the Missouri COSIG Project. More recently, Stilen served as primary author on the classroom version of the *NIDA/SAMHSA Blending Initiative, S.M.A.R.T. Treatment Planning Utilizing the Addiction Severity Index (ASI): Making Required Data Collection Useful (2005)*.

- ☞ *Concurrent Session 3C ~ Treatment Planning M.A.T.R.S.: Utilizing the ASI to Individualize Client Plans* ~ Friday, 10:30 a.m. – 12:00 p.m.

Mike Stone, Executive Director, Kentucky Council on Problem Gambling. Stone leads *MKS Communications*, an enterprise he started in 1998 with his wife, Kris. They provide management, writing, publicity, planning, and event services to associations, charities, and businesses. Clients include the Kentucky Association for Career and Technical Education and the Kentucky Council on Problem Gambling.

Stone is an at-large member of the National Council on Problem Gambling Board of Directors. He is the in-coming president of the Association for Career and Technical Education National Executive Directors' Association. Stone holds bachelor's degrees in journalism and arts, majoring in political science, from the University of Missouri-Columbia. He has been a weekly newspaper editor and managing editor, a municipal zoning enforcement officer, and an association executive director.

- ☞ *Concurrent Session/Panel Discussion 15F ~ Effective Public Relations on a Shoestring Budget ~ Sunday, 8:30 – 10:00 a.m.*
- ☞ *Concurrent Session/Panel Discussion 17E ~ Lobbying and Advocacy: What Is It? Can Councils and Counselors Do It? ~ Sunday, 10:30 a.m. – 12:00 p.m.*

Peggy Thomas, B.A., is the Program Services Manager of ONTRACK Program Resources, Inc., a nonprofit consulting firm working to help raise the standard of practice in human services programs serving high need populations. In addition to overseeing the administrative and contracts management processes, Ms. Thomas provides consulting services to clients in the areas of community organizing, outreach, marketing, program development and administrative management. Ms. Thomas has worked with various public agencies, community and faith-based organizations to help bring about understanding and change in dealing with the issues related to substance abuse. Ms. Thomas has a Bachelor of Arts degree in Communications Studies from California State University, Sacramento.

- ☞ *Concurrent Session 17A ~ Building Multicultural Coalitions: Lessons Learned from the Creation of the California Problem Gambling Prevention Coalition ~ Sunday, 10:30 a.m. – 12:00 p.m.*

Nicole Tremblay, Ph.D., works for Laval University since 2005 in collaboration with Bob Ladouceur. She is actually in charge of the evaluation of the new improved self-exclusion service implanted in the Montreal's Casino as a pilot project since November 2005. She is also specialized in research protocols and methodology that she teaches at UQAM University.

- ☞ *Concurrent Session 15A-1 ~ Improved Responsible Gaming Strategies: Self-Exclusion and Onsite Casino Centre ~ Sunday, 8:30 – 10:00 a.m.*

Mark Vander Linden, M.S.W., is the Coordinator of the Iowa Gambling Treatment Program at the Iowa Department of Public Health. In this position he oversees all contracts related to gambling treatment, prevention, helpline, media and research in the state of Iowa. He has also has extensive experience as a clinical social worker and program manager working with children and families, substance abuse and HIV/AIDS.

- ☞ *Concurrent Session 3A ~ Useful Problem Gambling Treatment Outcomes Monitoring ~ Friday, 10:30 a.m. – 12:00 p.m.*
- ☞ *Concurrent Session 12D ~ Community Mobilization: Multistate Collaboration of Problem Gambling Treatment, Training, and Prevention Strategies ~ Saturday, 1:30 – 3:00 p.m.*

Harlan H. Vogel, M.S., NCGC, CCGC, LPC, has specialized in the area of pathological gambling since 1995. He is nationally certified & state certified in Nebraska as a pathological gambling counselor. Harlan is currently the clinical coordinator for the treatment of pathological gamblers at Heartland Family Service in Council Bluffs, Iowa & Omaha, Nebraska has presented educational workshops in Iowa, Nebraska, Arizona, and Kansas; he has also been a presenter at a national conference. He is currently on the board for the Nebraska Council on Compulsive Gambling, and the certification board for gambling counselors in Nebraska.

- ☞ *Poster Session 6A ~ Treatment Protocol for the Integrated Treatment of Clients Diagnosed as Pathological Gamblers ~ Saturday, 10:00 – 10:30 a.m.*

Doug Walker, Ph.D., is an associate professor of economics at Georgia College, in Milledgeville, GA. His research interest is in the economics of casino gambling, including economic growth effects and social costs of casino gambling. His new book, "The Economics of Casino Gambling" is published by Springer.

- ☞ *Concurrent Session 15C ~ The Missing Link Between Gambling Research and Policy: Cost-Benefit Analysis ~ Sunday, 8:30 – 10:00 a.m.*

Kristy Wanner, M.Ed., is the gambling prevention coordinator at the University of Missouri-Columbia and is responsible for providing support and coordination for gambling prevention among the twelve public universities in Missouri as part of a statewide coalition (Partners in Prevention). She is currently working on her doctorate in Health Education and Promotion with an emphasis area in athletic and public health. She has a master's degree in Counseling Psychology (specializing in sport) from the University of Missouri-Columbia and is a nationally certified gymnastics coach.

- ☞ *Concurrent Session 10B ~ Rolling the Dice: Gambling with College Life. Examining a State's College Problem Gambling and Substance Abuse Prevention Programs ~ Saturday, 10:30 a.m. – 12:00 p.m.*

Marlene D. Warner, M.A., has worked in nonprofit organizations for nearly a decade. She joined the Massachusetts Council on Compulsive Gambling in 2001 as the Program Director. Since that time, Ms. Warner has developed programs for and trained thousands of professionals in the substance abuse, mental health, corrections, senior services and financial services fields across the Commonwealth. In addition, she has presented at national and international conferences on the topic of disordered gambling.

- ☞ *Concurrent Session 17C ~ Building the Capacity of Colleges and Universities to Address Problem Gambling ~ Sunday, 10:30 a.m. – 12:00 p.m.*

Joe Westermeyer, M.D., Ph.D., is Professor of Psychiatry at the University of Minnesota and medical director of the Addictive Disorders Service at the Minneapolis VA Medical Center (which includes services for gambling problems). He has studied the distribution of Pathological Gambling and gambling problems among veterans receiving mental health services. Among his publications are community-based studies of gambling and associated health among American Indian and Hispanic veterans. Currently he is conducting a study of gambling among veterans seeking care in the Southwest and North Central Region, including a subgroup of recently deployed veterans returning from Iraq and Afghanistan. He co-chairs a VA grant committee on Health Services Research, and he chairs the Addiction Psychiatry Certification Committee of the American Board of Psychiatry and Neurology.

- ☞ *Concurrent Session 15B-1 ~ Demographics, Cultural, and Psychiatric Correlates of Gambling Among Native American Veterans ~ Sunday, 8:30 – 10:00 a.m.*

Jim Wuelfing, B.S., CPP-R, NRRP, is the Director of Prevention for the Massachusetts Council on Compulsive Gambling and also serves as a Prevention Consultant with Problem Gambling Services in Connecticut. Jim owns The New England Center, a training and consulting firm in Massachusetts. He has served clients in 42 states and in Europe. He has been on the faculty of the New England School of Alcohol Studies for fifteen years and on the faculty of the planning committee and the faculty of the New England School of Prevention Studies since its inception in 2001. He has been a consultant to several prevention of problem gambling initiatives across the country.

- ☞ *Concurrent Session 17C ~ Building the Capacity of Colleges and Universities to Address Problem Gambling ~ Sunday, 10:30 a.m. – 12:00 p.m.*

NCPG 2007 Awards

2007 Media Award - Electronic
Set of 4 commercials: “Understanding”, “Symptoms”, “Lying”, and “Consumes You”
The Manahan Group and The Media Center

2007 Media Award - Print
“Asian Outreach Initiative”
The World Journal

2007 Outstanding Contributor In The Field:
Dr. Norm Kruedelbach

2007 Research Award
Dr. Marc Potenza

2007 Student Dissertation Award
Dr. Katherine M. Diskin, University of Calgary
“Effects of a Single Session Motivational Intervention
on Problem Gambling Behavior”

2007 Student Masters Thesis Award
Mariko Ono, Smith College
“When Does Playing For Fate Lead To Addiction?
An Exploratory Study of the Role of Cultural Factors In
Chinese Male Gambling Behavior”

2007 People’s Choice Award - Print Campaign

2007 People's Choice Award - Print Campaign Submissions

The 2007 People's Choice Award will be awarded in the category of Best Print Campaign, and will be given to the most popular public awareness message as voted on by the attendees at the National Council on Problem Gambling annual national conference, the oldest and largest problem gambling conference in the world.

There was a limit of one submission per organization. Eligible materials include any problem gambling/responsible gaming public service or paid advertising that was printed on a poster, flyer, newspaper, magazine, or other medium. Many of the submissions were also provided in a digital format, and are included on the conference CD-Rom for your reference after the conference.

The submissions will be displayed in the Exhibit Hall throughout the conference.

Ballot boxes will be open for voting from 9 a.m. on Friday to 11:30 a.m. on Saturday. Please vote only once.

The award will be presented during the Award Luncheon on Saturday (June 9).

Your submissions for the 2007 People's Choice Award - Best Print Campaign:

Submission Title: **"If Poker Becomes a Problem..."**

Format: Poster

Printed Dimensions: 16 x 20

Sponsoring Organization:

California Office of Problem Gambling

Contact: Steve Hedrick,

shedrick@adp.ca.gov

Designer (if different than sponsor):

Kevin Juan (college student)

Designer Contact Information:

kjuan@adp.ca.gov



Submission Title: **"Lost"**

Format: Poster

Printed Dimensions: 8.5 x 11

Sponsoring Organization:

Northstar Problem Gambling Alliance

Contact: npga@frontiernet.net

Designer (if different than sponsor):

Colle & McVoy

Designer Contact Information:

Tony Saucier; tony.saucier@collemcvoy.com

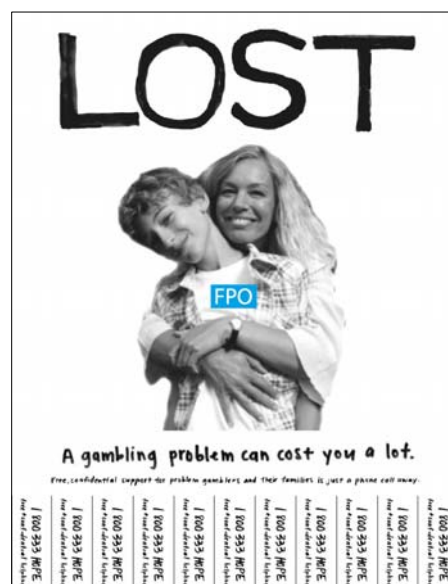

Submission Title: **"Hope and Help"**

Format: Poster

Printed Dimensions: 15.5 x 23

Sponsoring Organization:

Missouri Alliance to Curb Problem Gambling

Contact: Shelly Perez; perezs@molottery.com

Designer Contact Information:

Sonja Bechel; beches@molottery.com



Submission Title: **"Throw It Away"**

Format: Poster

Printed Dimensions: 17 x 22

Sponsoring Organization:

Atlantic Lottery Corporation

Contact: Kim Wilson; kim.wilson@alc.ca

Designer (if different than sponsor):

SGCI, Inc.

Designer Contact Information:

Nelson Cabral; 506-364-1765

Note: two posters included on conference CD-Rom



Submission Title: **"What TV and Movies Say"**

Format: Poster

Printed Dimensions: 11 x 17

Sponsoring Organization:

Oregon Department of Human Services, Problem Gambling Services

Contact: Greta Coe; greta.l.coe@state.or.us

Designer (if different than sponsor):

Olivia Mescos, 8th grade student

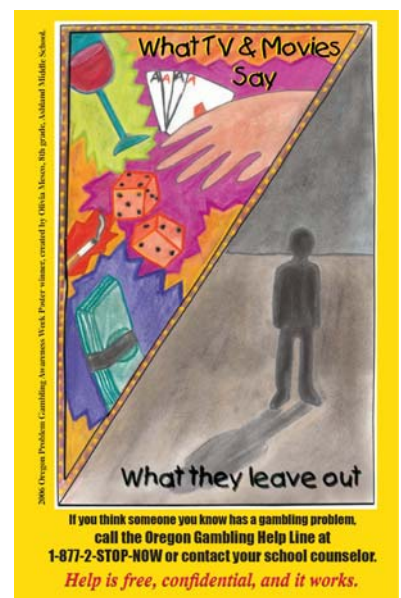

Submission Title: **"Problem Gambling Affects Everyone"**

Format: (General Information) Brochure

Printed Dimensions: 3 7/8 x 8 3/4

Sponsoring Organization:

Washington State Problem Gambling Program

Contact: Linda Graves; gravell@dshs.wa.gov

Designer (if different than sponsor):

Washington Department of Printing; and
Linda Graves

Note: Entire brochure is included on conference CD-Rom, in both English and Spanish

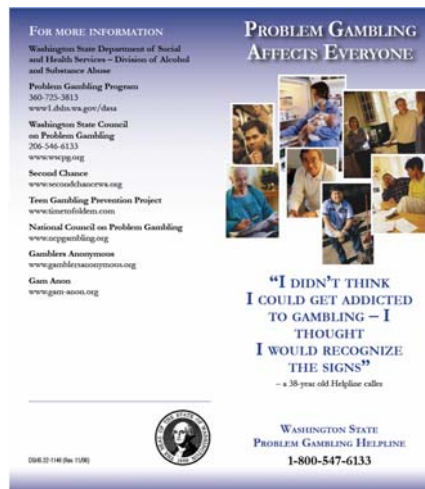

Submission Title: **"Know a Friend Who's Lost in the Shuffle"**

Format: Poster

Printed Dimensions: 13 x 17

Sponsoring Organization:

Responsible Gambling Council (Ontario)

Contact: Susan Saundercok; susans@rgco.org

Designer (if different than sponsor):

FUEL Advertising

Designer Contact Information:

Marian Magrane; 416-218-3243



Submission Title: **"So You Think I'm Hot"**

Format: Poster

Printed Dimensions: 13 x 17

Sponsoring Organization:

Manitoba Gaming Control Commission

Contact: Andrea Kowal; akowal@mgcc.mb.ca



Submission Title: **"Once Gambling Starts..."**

Format: Poster

Printed Dimensions:

Sponsoring Organization:

Wisconsin Council on Problem Gambling

Contact: Rose Gruber; wcpgamble5-

rose@new.rr.com



Submission Title: **"Not Just A Game of Chance"**

Format: Brochure/Booklet

Printed Dimensions: 8.5 x 8.5

Sponsoring Organization:

New York State Office of Alcoholism and Substance Abuse Services

Contact: Rebecca Martell;

rebeccamartell@oasas.state.ny.us

Designer (if different than sponsor):

Dream Catchers Communications

Designer Contact Information:

Mary Beth Mooney; dreamcat@nycap.rr.com

Note: Entire brochure is included on conference CD-Rom

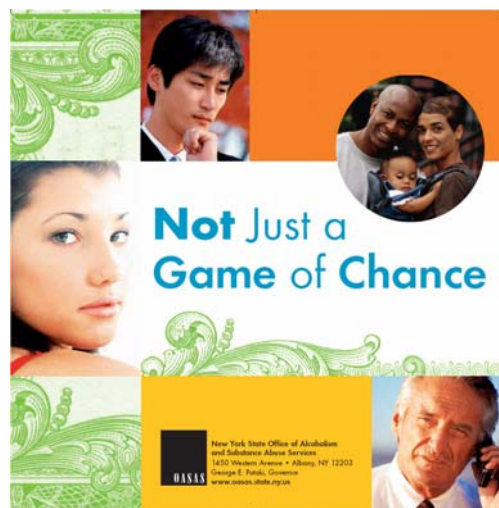

Submission Title: **"2007 Oregon Problem Gambling Campaign"**

Format:

Printed Dimensions:

Sponsoring Organization:

Oregon Lottery

Contact: Jeffrey Marotta

Designer (if different than sponsor):

Troika / Oregon Lottery

Designer Contact Information:

Brian Sullivan; brian.sullivan@state.or.us

**Thank you for participating in the
21st Annual Conference on
Problem Gambling Prevention,
Research, Recovery & Treatment.
The contributions of each participant
helps to make this conference a
powerful learning experience.**

2007 Conference Planning Team

Special thanks to the conference committee and staff for their tireless assistance in the preparation and delivery of this conference. Their donations of time and services are without price and helped ensure the success of this conference.

Conference Committee

Iowa Department of Public Health

Mark Vander Linden, Iowa Gambling Treatment Program Administrator

Kansas Association of Addiction Professionals

Lisa Carter, Director of Operations

Kansas Coalition on Problem Gambling

Joyce Markham

Mid-America Addiction Technology Transfer Center

Debbie Rockford, Conference Coordinator

Pat Stilen, Director

Jan Wrolstad, Associate Director

Minnesota State Lottery

Don Feeney, Research and Planning Director

Missouri Council on Problem Gambling Concerns, Inc.

Michelle Jakobe, Member

Daniel Smith, Member

Keith Spare, President

Missouri Gaming Commission

Melissa Stephens, Problem Gambling Programs Administrator

Missouri Lottery

Shelly Perez, Responsible Gaming Program Coordinator

Missouri Gaming Association

Mike Ryan, Member

National Council on Problem Gambling

Linda Abonyo, Program Manager

Renee Cunningham-Williams, Member

Joanna Franklin, Board Member

Richard Rosenthal, Member

Keith Whyte, Executive Director

Nebraska Council on Compulsive Gambling

Jerry Bauerkemper, Executive Director

Nebraska Department of Health and Human Services, Division of Behavioral Health Services, Gamblers Assistance Program

Eric Hunsberger, Program Manager

Northstar Problem Gambling Alliance

Lance Holthusen, Executive Director

Oklahoma Association for Problem and Compulsive Gambling, Inc.

Michael H. Smith, Executive Director

Prairielands Addiction Technology Transfer Center (PATTC)

Martin Goransson, Project Manager - Gambling Projects

Candace Peters, Director of Training

Anne Helene Skinstad, Project Director

Kate Speck, PATTC Nebraska Coordinator

Conference Contributors, Volunteers, and Staff

ACT Missouri

Katrina Wieberg, Director – Finance and Operations

Eisenbarth & Associates

Ron Eisenbarth

Iowa Department of Public Health

Robert Kerksieck, Health Facilities Surveyor for Gambling Treatment Programs
Tom Newton, Director

Kansas Association of Addiction Professionals

Georganne Corral, Meeting and Events Coordinator
Claudia Larkin, Executive Director
Mike Larkin, Program Director

Kansas Department of Social & Rehabilitation Services, Health Care Policy, Addiction and Prevention Services

Charles Bartlett, Project and Policy Coordinator

Missouri Department of Mental Health, Division of Alcohol & Drug Abuse

Nora Bock, Mental Health Manager

Missouri Council on Problem Gambling Concerns, Inc.,

Stan Bier, Vice President
Jack Buchan, Treasurer
Rick Cox, Member
Arlene Miller, Secretary

Missouri Gaming Association

Matt Block, Responsible Gaming Committee Chairman

Missouri Gaming Commission

Annette Turner, Problem Gambling Administrative Assistant

Missouri Lottery

Kami Delameter, Public Affairs Assistant
Sonja Bechel, Multimedia Designer

Missouri Lottery Education Telecommunication Services

Julie Boeckmann, Assistant to the Director of Telecommunications Services
Frank Finley, Producer/Production Manager
John Wells, Video Producer

National Council on Problem Gambling

Melissa Martin, Administrative Assistant

Nebraska Council on Compulsive Gambling

Susan Hogueison, Help Line Director

Nebraska Department of Health and Human Services, Division of Behavioral Health Services

Ron Sorenson, Administrator

Oklahoma Department of Mental Health & Substance Abuse Services

Jennifer Glover, Director of Treatment Services

Prairielands Addiction Technology Transfer Center (PATTC)

Ros Hayslett, Project Coordinator
Tegan M. Zimmerman, Student/Office Assistant

Conference Sponsors*

The Conference Committee and Staff would like to extend a very special thank you to the following sponsors and scholarship providers for their support. This conference would not have been possible without their invaluable support.*

Platinum Sponsors

Missouri Gaming Commission
Missouri Lottery
Potawatomi Bingo/Casino
Substance Abuse and Mental Health Services Administration, Center for Substance Abuse Treatment,
U.S. Department of Health and Human Services

Gold Sponsors

Harrah's Entertainment
International Gaming Technology (IGT)
Iowa Department of Public Health, Gambling Treatment Program
Nebraska Behavioral Health Services, Gamblers Assistance Program

Silver Sponsors

Port Authority of Kansas City

Bronze Sponsors

Dover Downs
GTECH Corporation

Associate Sponsors

Iowa Gaming Association
Missouri Gaming Association
Pollard Banknote

Scholarship Providers

Iowa Department of Public Health, Gambling Treatment Program
Kansas Coalition on Problem Gambling
Mid-America ATTC
Missouri Department of Mental Health, Division of Alcohol & Drug Abuse

Sponsors Providing In-Kind Services:

Ameristar Casino Kansas City
Eisenbarth & Associates
Kansas Association of Addiction Professionals
Kansas Coalition on Problem Gambling
Mid-America ATTC
Minnesota State Lottery
Missouri Alliance to Curb Problem Gambling
Missouri Council on Problem Gambling, Inc
Nebraska Council on Compulsive Gambling
Northstar Problem Gambling Alliance
Oklahoma Association on Problem & Compulsive Gambling
Oklahoma Department of Mental Health & Substance Abuse Services
Prairielands ATTC

This conference is supported in part by the Substance Abuse and Mental Health Services Administration, Center for Substance Abuse Treatment, U.S. Department of Health and Human Services. This support does not imply endorsement by SAMHSA/CSAT or by the Federal Government of any conference activities or oral or written information presented at, or resulting from, the conference.

*Conference Sponsors and Scholarship Providers as of May 11, 2007

Conference Exhibitors

Algamus Recovery Centers

Contact: Rick Benson, Director
PO Box 1227

Anna Maria, FL 34216

Phone: (941) 778-2496

algamus@aol.com

www.algamus.org

We are gambling-specific, residential treatment centers in Florida and South Carolina providing a continuum of problem/pathological gambling services.

Behavior Data Systems, Ltd.

Contact: Melanie Karca, Corporate Liaison

2400 N Central Ave, #450

Phoenix, AZ 85004

Phone: (602) 234-3506

Fax: (602) 266-8227

melanie@bdsLtd.com

www.BDSLTD.com

BDS designs tests for evaluating specific client populations. All of our assessment instruments have a truthfulness scale and built-in Truth-Corrected scoring procedures. Moreover, each of these tests has an Alcohol and Drug Scale, along with other measures or scales unique to the client population for which the test is designed to evaluate.

Cascadia

Contact: Peter Walsh, Program Manager

2415 SE 43rd, Suite 200

Portland, OR 97206

Phone: (503) 872-0151

Fax: (503) 239-5953

pwalsh@cascadiabhc.org

Cascadia is the largest provider of gambling treatment services in Oregon, with outpatient programs in Portland and Salem. It is the only residential gambling treatment program in the state, located in Salem.

CeDAR – Center for Dependency, Addiction & Rehabilitation

Contact: Diane Sanders, Marketing Specialist

PO Box 6510, MS F-786

Aurora, CO 80045

Phone: (720) 848-3007

Diane.Sanders@uch.edu

www.CeDARColorado.org

CeDAR is a 50-bed residential evaluation and treatment facility for adults (18 years and older) afflicted with substance dependence, alcoholism, and co-occurring disorders. Our program provides a supportive setting for patients and their families, allowing time for reflection, change, and recovery.

Choices Treatment Center, Inc.

Contact: Wanda Swanson, CCGC

2737 N 49th St

Lincoln, NE 68504

Phone: (402) 476-2300

Fax: (402) 476-2337

WandaSwanson@alltel.net

Treatment providers for problem/pathological gambling, substance abuse, mental health, family, prevention, awareness.

Hazelden Publishing

Contact: Marjie Bibeau, Sales Manager

PO Box 173 RW3

Center City, MN 55012

Phone: (800) 328-9000 ext 4689

Fax: (651) 213-4590

mbibeau@hazelden.org

www.hazelden.org

Hazelden, with nearly 60 years of knowledge and experience, addresses the full range of patient, family, and professional needs, including treatment and continuing care for youth and adults, research, higher learning, public education, and publishing.

Hollifield Associates

Contact: Ann E Fields, President

3006 NE 111th Circle

Vancouver, WA 98686

Phone: (360) 606-1684

aefields@comcast.net

www.hollifieldassociates.com

Consultant/MINT trainer – provide consultation and training on motivational interviewing and on my five-session “MI Group Model: Motivational Enhancement Therapy for Problem and Pathological Gamblers”.

Iowa Department of Public Health, Gambling Treatment Program

Contact: Mark Vander Linden

Iowa Department of Public Health

Lucas Office Building, 6th Floor

321 East 12th St

Des Moines, IA 50319-0075

Phone: (515) 281-8802

Fax: (515) 281-4535

mvanderlinden@idph.state.ia.us

www.1800betsoff.org

Provides services for families, concerned persons, and gamblers affected by problem gambling. Iowans can call 1-800-BETS OFF (1-800-238-7633) help line or visit the Web site for information on problem gambling services.

Kansas Coalition on Problem Gambling

Contact: Jean Holthaus or Duane Olberding
2209 SW 29th St.

Topeka, KS 66611

Phone: (785) 266-8666

Fax: (785) 266-3833

jholthaus@parstopeka.com

www.ksproblemgambling.org

The Kansas Coalition on Problem Gambling is dedicated to solving the social issues of problem gambling. Our mission is to reduce the onset and progression of problem gambling.

**Kathy Austin, Executive Representative –
Jordan Essentials (formerly Country Bunny
Bath & Body)**

Phone: (417) 926-6557

kathyaustin@bunnymart.com

www.jordanessentials.com

Family friendly products including lotion bars, shea butter, salt scrubs, face care, aromatherapy, etc.

KeyStone Center

Contact: Kathy MacMoran, Community Relations
2007 Providence Ave.

Chester, PA 19013

Phone: (484) 490-1060 x33

Fax: (610) 876-2450

Kathryn.MacMoran@uhsinc.com

KeyStone Center is dedicated to providing affordable quality treatment for adults with drug & alcohol, gambling, and/or sex addiction issues. Licensed as a dual diagnosis facility, we offer detox and rehab for men and women with significant mental health impairment. We have adolescent programs and offer RTF, PHP, IOP, and OP for males with mental health issues. WE also provide a full continuum of services for adults with drug, alcohol and gambling problems.

Keystone Treatment Center

Contact: Karen Hagerty

7511 S. Louise Ave.

Sioux Falls, SD 57108

Phone: (605) 335-1820

Fax: (605) 335-3282

khagerty@crchealth.com

www.keystonetreatment.com

Substance abuse & gambling treatment - serving adolescents and adults.

Mid-America ATTC

Contact: Jan Wrolstad, Associate Director
University of Missouri-Kansas City

5100 Rockhill Road

Kansas City, MO 64110-2499

Phone: (816) 482-1150

Fax: (816) 482-1101

Wrolstad@mattc.org

www.mattc.org

Mid-America ATTC is a regional center in a larger network covering the United States. Addiction Technology Transfer Centers are funded by SAMHSA/CSAT. A primary goal of the ATTC network is to develop the workforce by transferring addiction science and research to providers of treatment services. The ATTC vision is to unify science, education and services to transform lives.

**Missouri Alliance to Curb Problem
Gambling**

PO Box 104591

Jefferson City, MO 65110

Phone: (573) 526-4080; (573) 526-7467

Fax: (573) 526-1999

betsoff@molottery.com

www.888BetsOff.org

Speakers bureau and a variety outreach materials and resources for problem gambling, underage gambling prevention and responsible gambling, etc. All resources are provided free of charge to Missouri residents.

Missouri Division of Alcohol & Drug Abuse

Contact: Nora Bock, Mental Health Manager

Missouri Department of Mental Health

PO Box 687

Jefferson City, MO 65102-0687

Phone: (573) 751-4942

www.dmh.mo.gov/ADA/adaindex.htm

**Missouri National Guard Counterdrug Task
Force**

9503 N Congress Ave.

Kansas City, MO 64153

Phone: (816) 891-9910

Fax: (816) 891-9915

www.moguard.com/counterdrug

Plain's States Zonal Forum of Narcotics

Anonymous

Contact: Barry B., Public Relations Contact

P.O. Box 5164

Des Moines, Iowa 50306-5164

Phone: (712) 329-8595

Fax: (712) 691-2179

Email: webservant@pszfna.org

pszfna.org

Narcotics Anonymous is an international, community-based association of recovering drug addicts with more than 33,500 weekly meetings in 116 countries worldwide. We have no dues or fees. Narcotics Anonymous is open to all drug addicts, regardless of the particular drug or combination of drugs used. The Plain's States Zonal Forum of N.A. is an administrative body that seeks to coordinate NA service efforts throughout the Great Plains of the United States.

Port Authority of Kansas City

Contact: Steve Rinne, Assistant Director

1100 Walnut, Suite 1700

Kansas City MO 64106

Phone: (816) 691-2129

Fax: (816) 691-2179

Email: srinne@edckc.com

The Port Authority of Kansas City (Missouri) Problem Gaming Fund provides funding for awareness, education, outreach, and research of problem gambling issues. Funded by contributions from the Ameristar and Isle of Capri casinos, the fund has awarded \$750,000 in grants since 2001. Our booth will feature materials from our grant recipients.

Prairielands ATTC

Contact: Candace Peters, Director of Training

University of Iowa College of Public Health

1207 Westlawn

Iowa City, IA 52242

Phone: (319) 335-5362

Fax: (319) 335-6068

candace-peters@uiowa.edu

www.public-health.uiowa.edu/pattc

Prairielands ATTC serves five states in the Midwest (Iowa, Minnesota, North Dakota, Nebraska, and South Dakota), with a primary mission to disseminate best practices in substance abuse and problem gambling thereby bridging the gap between science and service. Prairielands ATTC provides technical assistance, training, and systems change assistance throughout the five-state region with primary focus on Native American issues, Problem Gambling, Cultural Competencies, Co-Occurring Disorders, and Workforce Development.

S.A.S.H.

Contact: Robin Cato

PO Box 725544

Atlanta, GA 31139

Phone: (770) 541-9912

Fax: (770) 541-1566

sash@sash.net

sash.net

The Society for the Advancement of Sexual Health (SASH) offers hope and valuable resources to those seeking information about sexual addiction.

Silver Source II

Contact: Becky May, President/Owner

19012 E 31 Terr Ct S

Independence, MO 64057

Phone: (816) 699-2110

Fax: (816) 795-1239

Silversource2@sbcglobal.net

Offer a full line of sterling silver jewelry, including: chains, omegas, earrings, pendants with and without stones, bracelets & rings, Swarovski bracelets, interchangeable rings, beads...

S.P.I.C.E.

Contact: Jean Holthaus, Program Director

2209 SW 29th St

Topeka, KS 66611

Phone: (785) 266-8666

Fax: (785) 266-3833

jholthaus@parstopeka.com

www.parstopeka.com

S.P.I.C.E. (Senior Prevention Intervention Counseling Education) addresses problem gambling, substance abuse, and other problem behaviors among elder adults.

SAVE THE DATE!



MARCH 9-15, 2008

6th Annual National Problem Gambling Awareness Week.

National Problem Gambling Awareness Week (NPGAW) is the only national grassroots public awareness effort that focuses on problem gambling.

The goal of the campaign is to educate the general public and health care professionals about the warning signs of problem gambling and raise awareness about the help that is available both locally and nationally.

The reach of the 2007 campaign was impressive. Over 120 organizations and individuals in 24 states formally participated in the events during the week. Our public awareness effort included print, radio and TV Public Service Announcements (PSA). The PSA's were distributed nationwide, with the radio release broadcast 551 times in 39 states to an audience of 89.4 million. Three print stories generated 408 articles in 25 different states with 26.2 million potential readers. The two TV spots were broadcast 182 times in 29 different states to an audience of 132.9 million viewers. Coverage at local, regional and national level resulted in a great deal of earned media, including California Public Radio, Forbes and CNN Headline News. Full page ads were placed in Global Gaming Business and Lottery Insights magazines.

Every event and article was a chance for a problem gambler or a family member to learn of the hope and help available.

For more information, go to www.npgaw.org and download over 50 free screening tools, posters, flyers, brochures and fact sheets for use by counselors, physicians, teachers, state and non-profit agencies and companies at the state and local level.

We urge everyone to join together in this great campaign.



National Council
on Problem Gambling

SAVE THE DATE!

*22nd Annual Conference on
Problem Gambling Prevention, Research,
Recovery & Treatment*

June 27-29, 2008 ~ Long Beach, CA

www.ncpgambling.org &
www.calproblemgambling.org

SAVE THE DATE!



2008 Midwest Conference on Problem Gambling & Substance Abuse

August 13-15, 2008 ~ St. Louis, Missouri

Workshops will focus on clinical application, research, public policy, industry, regulation, recovery, and special populations.

We are excited to announce that we will again be offering a pre-conference training (due to the tremendous popularity of the pre-conference training on ethics in 2006)! Based on participant feedback, the 2008 pre-conference training will be on Motivational Interviewing, featuring nationally known MINT trainers.

So, mark you calendars! You don't want to miss this one!

Tentative Timeline:

August 2007: Call for Presentations, Posters, and Exhibits Issued

December 31, 2007: Call for Presentations Deadline

Spring 2008: Speakers and Workshops Announced

May 31, 2008: Call for Posters Deadline

June 30, 2008: Early Bird Registration Discount Ends

Details will be posted on the Conference Web site as they become available:
www.888BetsOff.org/links/Midwest_Conference.shtm

WHY YOU SHOULD ATTEND THIS CONFERENCE:

The Midwest Conference offers you an opportunity to learn from nationally recognized experts in the field of gambling treatment and substance abuse. You will learn how to recognize and treat clients affected by mental health or substance abuse issues co-occurring with gambling/problem gambling behaviors, and learn more about persons who gamble and their families who are affected by their problem gambling behavior. You can interact with a community committed to making a difference in their lives, network with state certified gambling treatment counselors, discover resources available, and learn how to provide quality services for persons with problem gambling behaviors.

